



GOVERNMENT GAZETTE

OF THE

REPUBLIC OF NAMIBIA

N\$7.00

WINDHOEK - 15 February 2007

No. 3788

CONTENTS

GOVERNMENT NOTICES

Page

No. 9	Imposition of Levy for harvesting of Marine Resources: Marine Resources Act, 2000 ..	3
No. 10	Reclassification of District Road 3443, Proclamation of a portion of trunk road 15/1, a portion of district road 3600 be reclassified and a portion of district road 3600 be closed: Districts of Rundu and Tsumeb	4
No. 11	Deviation of District Road 3610: District of Tsumeb	5
No. 12	Proclamation of District Roads (Numbers 3620, 3622, 3632 and 3634): District of Eenhana	5
No. 13	Proclamation of District Roads: District of Outapi	6
No. 14	Proclamation of District Road 3231 and the decrease of the road reserve width of the said road: District of Outjo	7
No. 15	Proclamation of a portion of District Road 3654: District of Tsumeb	8
No. 16	Notification of Farming Units offered for Allotment: Agricultural (Commercial) Land Reform Act, 1995	9
No. 17	Aris Town Planning Scheme: Town Planning Ordinance, 1954	11
No. 18	Kappsfarm Town Planning Scheme: Town Planning Ordinance, 1954	12
No. 19	Otjiwarongo Town Planning Amendment Scheme No. 9: Town Planning Ordinance, 1954	12
No. 20	Walvis Bay Amendment Scheme No. 13: Town Planning Ordinance, 1954	12

GENERAL NOTICES

No. 18	Nursing Council of Namibia: Amendment of Government Notice No. 357 of 24 November 2006	13
No. 19	Namibia Financial Institutions Supervisory Authority: Irregular or Undesirable Practice ..	13

No. 20	National Heritage Council of Namibia: Declaration of an Area to be a Conservation Area: National Heritage Act, 2004	13
No. 21	Compilation of Henties Bay Town Planning Amendment Schemes No. 7 to 10	17
No. 22	Stampriet Village Council: Water Supply Tariffs, Fees and Other Charges	17
No. 23	Stampriet Village Council: Levying on Rates and Rateable Property	20
No. 24	Permanent Closure of Portions A, B and C of Erf 2372, Ondangwa Extension 4 as Public Open Space	20
No. 25	Permanent Closure of Erf 310, Ohangwena as Public Open Space and Portions A and B of Erf 320, Ohangwena as Public Open Space	21
No. 26	Permanent Closure of Portion A of Erf 340, Oshikango as Public Open Space	21
No. 27	Establishment of the Townships: Engela-Omafo Extensions 1 to 4: Town Council of Helao Nafidi	22
No. 28	Establishment of the Township: Ziveli Lifestyle Village: Karas Regional Council	22
No. 29	Establishment of the Townships: Oshikango Extensions 2, 3, 4 and 5: Town Council of Helao Nafidi	23
No. 30	Establishment of the Townships: Ohangwena Extensions 1, 2 and 3: Town Council of Helao Nafidi	23
No. 31	Establishment of the Township: Tsandi Extension 1: Omusati Regional Council	24
No. 32	Establishment of the Townships: Onuuno and Onuuno Extensions 1, 2 and 3: Town Council of Helao Nafidi	24
No. 33	Establishment of the Township: Tseiblaagte Extension 5: Municipal Council of Keetmanshoop	25
No. 34	Keetmanshoop Town Planning Amendment Scheme No. 7	25
No. 35	Ongwediva Town Planning Amendment Scheme No. 2	26
No. 36	Walvis Bay Town Planning Amendment Scheme No. 14	26
No. 37	Walvis Bay Town Planning Amendment Scheme No. 15	26
No. 38	Swakopmund Town Planning Amendment Scheme No. 27	27
No. 39	Gochas Village Council: Water Supply Tariffs and Charges	27
No. 40	Gochas Village Council: Sewerage and Refuse Removal Tariffs and charges	28
No. 41	Gochas Village Council: Electricity Supply Tariffs and Charges	29
No. 42	Gochas Village Council: Burial fees, Rates and Taxes and grazing fees	31
No. 43	Omaheke Regional Council: Schedule of Approved Tariffs (2006/2007)	31
No. 44	Municipality of Windhoek: Amendment of Water Supply Regulations	33

Government Notices

MINISTRY OF FISHERIES AND MARINE RESOURCES

No. 9

2007

IMPOSITION OF LEVY FOR HARVESTING OF MARINE RESOURCES: MARINE RESOURCES ACT, 2000

In terms of section 44(4) of the Marine Resources Act, 2000 (Act No. 27 of 2000), after consultation with the Marine Resources Advisory Council and with the approval of the Minister of Finance, with effect from 1 March 2007 -

- (a) impose a levy for the benefit of the Fisheries Observer Fund in respect of the harvesting of marine resources as set out in the Schedule; and
- (b) repeal Government Notice No. 175 of 1 August 2003.

DR. A. IYAMBO
MINISTER OF FISHERIES AND
MARINE RESOURCES

Windhoek, 18 January 2007

SCHEDULE

1. A person who engages in harvesting in Namibian waters in terms of a right, an exploratory right or a fisheries agreement must pay a levy based on the category of the fisheries observer on board the fishing vessel as indicated in the Table:

Observer Category	Levy
FDA / Without observer on board	26.26
Trainee	26.26
Grade 1	26.26
Grade 2	27.45
Grade 3	28.64

for each hour during which that person is engaged in such harvesting, irrespective of whether or not a fish has been caught, but does not exceed 12 hours per day.

2. The person referred to in paragraph 1 must pay the levy referred to in that paragraph -
 - (a) to the Fisheries Observer Agency: PO Box 2903, Walvis Bay; and
 - (b) within 7 days of receipt of the invoice from the Fisheries Observer Agency.

MINISTRY OF WORKS, TRANSPORT AND COMMUNICATION

No. 10

2007

**RECLASSIFICATION OF DISTRICT ROAD 3443, PROCLAMATION OF A
PORTION OF TRUNK ROAD 15/1, A PORTION OF DISTRICT ROAD 3600 BE
RECLASSIFIED AND A PORTION OF DISTRICT ROAD 3600 BE CLOSED:
DISTRICTS OF RUNDU AND TSUMEB**

It is hereby made known -

- (a) in terms of section 22(2) of the Roads Ordinance, 1972 (Ordinance 17 of 1972), that the Minister has, in the districts of Rundu and Tsumeb
 - (i) under section 22(1)(b) of the said Ordinance declared the road described in Schedule I and Schedule II by co-ordinates and shown on sketch-map P2177 by the symbols B-C and E-F-D to be portions of a proclaimed road.
 - (ii) under section 22(1)(c) of the said Ordinance closed a portion of district road 3600 described in Schedule III and shown on sketch-map P2177 by the symbols D-E.
- (b) in terms of section 23(3) of the said Ordinance that the Minister has
 - (i) under section 23(1)(b) of the said Ordinance declared the roads referred to in paragraph (a)(i) to be a portion of trunk road 15/1.
 - (ii) under section 23(1)(e) of the said Ordinance amended the classification of a portion of district road 3443 described in Schedule IV and shown on sketch-map P2177 by the symbols A-B to be a portion of trunk road 15/1.
 - (iii) under section 23(1)(e) of the said Ordinance amended the classification of a portion of district road 3600 described in Schedule V and shown on sketch-map P2177 by the symbols C-D to be a portion of trunk road 15/1.

The said sketch-map shall at all times lie open to inspection at the office of the Roads Authority, Windhoek, during normal office hours.

SCHEDULE I

From a point (B on sketch-map P2177) at the junction with district road 3443 at the place known as Katope generally south-south-westwards across the common boundary of the districts of Rundu and Tsumeb to a point (C on sketch-map P2177) at the junction with district road 3600 at the place known as Onghuduva.

SCHEDULE II

From a point (E on sketch-map P2177) at the junction with main road 75 at the place known as Tsinsabis generally north-eastwards as described by the PI co-ordinates to a point (F on sketch-map P2177) at the place known as Tsitsol as described by the said co-ordinates; thence generally northwards to a point (D on sketch-map P2177) at the junction with district road 3600 at the Nkurenkure Gate (Veterinary Control) as described by the said co-ordinates.

POINTS	CO-ORDINATES
MR 75	18 46 19.8 S 17 57 49.1 E
Newpoint	18 46 06.8 S 17 58 05.8 E
Joint Curve	18 45 19.9 S 17 58 23.8 E
Fence 2	18 44 43.9 S 17 59 13.2 E
Fence 1	18 45 14.4 S 17 58 26.9 E
Tsitsol 01	18 44 11.9 S 18 00 01.8 E
Vetgate	18 31 37.9 S 17 59 57.02 E

SCHEDULE III

From a point (D on sketch-map P2177) at the junction with district road 3610 and the road described in Schedule IV at the Nkurenkure Gate (Veterinary Control) generally south-south-westwards and more and more south-south-eastwards to a point (E on sketch-map P2177) at the junction with main road 75 at the place known as Tsintsabis.

SCHEDULE IV

From a point (A on sketch-map P2177) at the junction with main road 110 at the place known as Mpungu generally south-south-westwards and more and more southwards to a point (B on sketch-map P2177) at the place known as Katope.

SCHEDULE V

From a point (C on sketch-Map P2177) at the junction with the road described in Schedule II at the place known as Onghuduva generally southwards to a point (D on sketch-map P2177) at the junction with district road 3610 at the Nkurenkure Gate (Veterinary Control).

MINISTRY OF WORKS, TRANSPORT AND COMMUNICATION

No. 11

2007

DEVIATION OF DISTRICT ROAD 3610: DISTRICT OF TSUMEB

In terms of section 22(2) of the Roads Ordinance, 1972 (Ordinance 17 of 1972), it is hereby made known that the Minister has under section 22(1)(c) of the said Ordinance, in the district of Tsumeb, deviated district road 3610 as described in paragraph (a) of the Schedule and shown on sketch-map P2172 by the symbols A-B-C-D, from the route so described and shown, to the route described in paragraph (b) of the Schedule and shown on the said sketch-map by the symbols A-E.

The said sketch-map shall at all times lie open to inspection at the office of the Permanent Secretary: Works, Transport and Communication, Windhoek, during normal office hours.

SCHEDULE

- (a) From a point (A on sketch-map P2172) in the district of Tsumeb at the junction with trunk road 1/11 generally eastwards to a point (B on sketch-map P2172); thence generally east-south-eastwards and more and more northwards to a point (C on sketch-map P2172); thence generally eastwards across the common boundary of the districts of Tsumeb and Rundu to a point (D on sketch-map P2172) at the junction with district road 3445.
- (b) From a point (A on sketch-map P2172) in the district of Tsumeb at the junction with trunk road 1/11 generally north-eastwards and more and more eastwards to a point (E on sketch-map P2172) at the junction with district roads 3600 and 3446 in the district of Tsumeb.

MINISTRY OF WORKS, TRANSPORT AND COMMUNICATION

No. 12

2007

PROCLAMATION OF DISTRICT ROADS (NUMBERS 3620, 3622, 3632 AND 3634): DISTRICT OF EENHANA

It is hereby made known -

- (a) in terms of section 22(2) of the Roads Ordinance, 1972 (Ordinance 17 of 1972), that the Minister has, in the district of Eenhana under section 22(1)(b) of the said Ordinance declared the roads described in Schedules I, II, III and IV and shown on sketch-map P2173 by the symbols A-B; C-D-E; F-G-H and I-J respectively, to be proclaimed roads.
- (b) in terms of section 23(3) of the said Ordinance that the Minister has under section 23(1)(c) of the said Ordinance declared the roads referred to in paragraph (a) to be district roads (numbers 3620, 3622, 3632 and 3634).

The said sketch-map shall at all times lie open to inspection at the office of the Roads Authority, Windhoek, during normal office hours.

SCHEDULE 1

From a point (A on sketch-map P2173) at the junction with main road 110 at the place known as Oupili generally southwards and more and more south-south-westwards to a point (B on sketch-map P2173) at the place known as Oshifitu.

SCHEDULE II

From a point (C on sketch-map P2173) at the junction with main road 110 generally north-north-westwards to a point (D on sketch-map P2173) at the place known as Oluwaya; thence generally north-eastwards and more and more north-north-westwards to a point (E on sketch-map P2173) at the place known as Onduna.

SCHEDULE III

From a point (F on sketch-map P2173) at the junction with main road 110 at the place known as Okongo generally northwards and more and more north-north-eastwards via the places known as Okamanya and Oshanashiwa to a point (G on sketch-map P2173); thence generally northwards to a point (H on sketch-map P2173) at the place known as Eendobe.

SCHEDULE IV

From a point (I on sketch-map P2173) at the junction with main road 110 generally south-south-eastwards and more and more south-eastwards via the place known as Oidiva to a point (J on sketch-map P2173) at the place known as Ekoka.

MINISTRY OF WORKS, TRANSPORT AND COMMUNICATION

No. 13

2007

PROCLAMATION OF DISTRICT ROADS: DISTRICT OF OUTAPI

It is hereby made known -

- (a) in terms of section 22(2) of the Roads Ordinance, 1972 (Ordinance 17 of 1972), that the Minister has, in the district of Outapi under section 22(1)(b) of the said Ordinance declared the roads described in Schedules I and II and shown on sketch-map P2174 by the symbols A-B and C-D respectively, to be proclaimed roads;
- (b) in terms of section 23(3) of the said Ordinance that the Minister has under section 23(1)(c) of the said Ordinance declared the roads referred to in paragraph (a) to be district roads (numbers 3655 and 3656).

The said sketch-map shall at all times lie open to inspection at the office of the Roads Authority, Windhoek, during normal office hours.

SCHEDULE I

From a point (A on sketch-map P2174) at the junction with district road 3641 generally north-north-westwards and more and more northwards to a point (B on sketch-map P2174) at the place known as Oshihole.

SCHEDULE II

From a point (C on sketch-map P2174) at the junction with district road 3615 at the place known as Elim generally north-eastwards to a point (D on sketch-map P2174) at the junction with main road 92.

MINISTRY OF WORKS, TRANSPORT AND COMMUNICATION

No. 14

2007

PROCLAMATION OF DISTRICT ROAD 3231 AND THE DECREASE OF THE ROAD RESERVE WIDTH OF THE SAID ROAD: DISTRICT OF OUTJO

It is hereby made known -

- (a) in terms of section 22(2) of the Roads Ordinance, 1972 (Ordinance 17 of 1972), that the Minister has, in the district of Outjo under section 22(1)(b) of the said Ordinance declared a portion of the road described in the Schedule and shown on sketch-map P2176 by the symbols A-B, to be a proclaimed road;

- (b) in terms of section 23(3) of the said Ordinance that the Minister has under section 23(1)(c) of the said Ordinance declared the road referred to in paragraph (a) to be district road 3654; and
- (c) in terms of section 3(b) of the said Ordinance that the Minister has under section 3(4)(aA) decrease the width of the road reserve of the road described in paragraph (b) to thirty metres.

The said sketch-map shall at all times lie open to inspection at the office of the Roads Authority, Windhoek, during normal office hours.

SCHEDULE

From a point (A on sketch-map P2176) at the junction with main road 67 on the farm Portion 1 (Twenthe) of Kleinbegin 117 generally east-north-eastwards across the said farm and the farm Remainder of Noodweide 232 to a point (B on sketch-map P2176) at the place known as the St Michael Mission on the last-mentioned farm.

MINISTRY OF WORKS, TRANSPORT AND COMMUNICATION

No. 15

2007

PROCLAMATION OF A PORTION OF DISTRICT ROAD 3654: DISTRICT OF TSUMEB

It is hereby made known -

- (a) in terms of section 22(2) of the Roads Ordinance, 1972 (Ordinance 17 of 1972), that the Minister has, in the district of Tsumeb under section 22(1)(b) of the said Ordinance declared a portion of the road described in the Schedule and shown on sketch-map P2175 by the symbols A-B-C-D-E-F, to be a proclaimed road.
- (b) in terms of section 23(3) of the said Ordinance that the Minister has under section 23(1)(c) of the said Ordinance declared the road referred to in paragraph (a) to be a portion of district road 3654.

The said sketch-map shall at all times lie open to inspection at the office of the Roads Authority, Windhoek, during normal office hours.

SCHEDULE

From a point (A on sketch-map P2175) at the junction with district road 3654 at the place known as Onamishu generally west-south-westwards to a point (B on sketch-map P2175) at the place known as Onambiga; thence generally south-south-westwards to a point (C on sketch-map P2175) at the place known as Oomanya; thence generally west-south-westwards to a point (D on sketch-map P2175) at the place known as Alweendo; thence generally south-south-westwards to a point (E on sketch-map P2175) at the place known as Amweelo; thence generally west-south-westwards to a point (F on sketch-map P2175) at the junction with trunk road 1/11 at the place known as Omuthya.

MINISTRY OF LANDS AND RESETTLEMENT

No. 16

2007

**NOTIFICATION OF FARMING UNITS OFFERED FOR ALLOTMENT
AGRICULTURAL (COMMERCIAL) LAND REFORM ACT, 1995**

In terms of section 39 of the Agricultural (Commercial) Land Reform Act, 1995 (Act No. 6 of 1995) I -

- (a) make known that copies of the allotment plans approved in respect of the farming units referred to in the Schedule will be available for public inspection at the places and time indicated in the Schedule; and
- (b) invite applications for the allotment of those farming units.

J. EKANDJO
MINISTER OF LANDS AND
RESETTLEMENT

Windhoek, 2 February 2007

SCHEDULE**1. Location and description of farming unit offered for allotment:**

Region	District	Name of Farm	Number of farming units Offered for allotment	Size in hectare (ha) of farming units	Land use of farming units
Omaheke	Gobabis	Wyoming No. 36	3	Unit A Measures 1734 ha Unit B Measures 1650 ha Unit C Measures 1654 ha	Livestock Livestock Livestock
Omaheke	Gobabis	Kansas No. 34	3	Unit A Measures 1681 ha Unit B Measures 1660 ha Unit C Measures 1631 ha	Livestock Livestock Livestock

2. Public inspection of allotment plans:

The allotment plans in respect of the farming units offered for allotment are available during office hours for public inspection at the offices referred to in paragraph 3(c) for a period of 30 days from the date of publication of this notice in the *Gazette*.

3. Application for allotment of a farming unit:

- (a) An application for allotment of a farming unit must be made on the prescribed form obtainable from any of the offices mentioned in paragraph 3(c).
- (b) In case of project development by a company or co-operative a duly completed application form must be accompanied by the detailed project proposal and a certified copy of the registration certificate or proof of registration of the company or the co-operative.
- (c) A duly completed application form must be delivered at or forwarded to any of the offices mentioned below and is to reach such office on or before the expiry of 30 days from the date of publication of this notice in the *Gazette*.

Physical Addresses:

The Deputy Director
Resettlement Division
2nd Floor, BRB, Building
Garten Street
Windhoek

The Regional Governor
Khomas Regional Council
Windhoek

The Regional Governor
The Government Building
Gobabis

The Regional Governor
Main Street
Tsumeb

The Regional Governor
Government Building
Katima Mulilo

The Regional Governor
Government Building
Keetmanshoop

The Regional Governor
Government Building
Mariental

The Regional Governor
Government Building
Hospital Street
Otjiwarongo

The Regional Governor
Government Building
Oshakati

The Regional Governor
Government Building
Opuwo

The Regional Governor
Government Building
Rundu

The Regional Governor
Government Building
Outapi

The Regional Governor
Akasia Building, Mittel Street
Swakopmund

Postal Address:

The Deputy Director
Resettlement Division
Private Bag 13343
Windhoek

The Regional Governor
P.O. Box 337
Windhoek

The Regional Governor
Private Bag 2277
Gobabis

The Regional Governor
P.O. Box 11196
Tsumeb

The Regional Governor
Private Bag 35002
Katima Mulilo

The Regional Governor
P.O. Box 384
Keetmanshoop

The Regional Governor
Private Bag 321
Mariental

The Regional Governor
P.O. Box 1682
Otjiwarongo

The Regional Governor
Private Bag 5543
Oshakati

The Regional Governor
Private Bag 502
Opuwo

The Regional Governor
Private Bag 2082
Rundu

The Regional Governor
Private Bag 523
Outapi

The Regional Governor
Private Bag 1230
Swakopmund

The Regional Governor
Government Building
Eenhana

The Regional Governor
Private Bag 2032
Eenhana

4. Minimum qualifications required to qualify for allotment

An applicant (other than a company or close corporation contemplated in section 41(7) of the Agricultural (Commercial) Land Reform Act, 1995 (Act No. 6 of 1995) must be a Namibian citizen who -

- (a) is 18 years of age or older;
- (b) has a background or interest in agriculture or related enterprises;
- (c) has been socially, economically, or educationally disadvantaged by past discriminatory laws or practices;
- (d) has relinquished any right in respect of agricultural land;

5. Rent payable in respect of farming units

A farming unit is to be leased for 99 years. The approximate rent payable monthly, in respect of a farming unit so leased for livestock farming, is N\$1,50 per large livestock unit and N\$0,50 per small livestock unit.

6. Lease Agreement

A successful applicant must enter into a lease agreement with the Minister of Lands and Resettlement.

**MINISTRY OF REGIONAL AND LOCAL GOVERNMENT,
HOUSING AND RURAL DEVELOPMENT**

No. 17

2007

**ARIS TOWN PLANNING SCHEME:
TOWN PLANNING ORDINANCE, 1954**

In terms of section 26(2) of the Town Planning Ordinance, 1954 (Ordinance No. 18 of 1954), I give notice that I have under section 26(1) of that Ordinance, read with section 27(1) thereof, approved the Aris Town Planning Scheme of the Regional Council of Khomas.

**J. PANDENI
MINISTER OF REGIONAL AND LOCAL
GOVERNMENT, HOUSING AND
RURAL DEVELOPMENT**

Windhoek, 23 January 2007

**MINISTRY OF REGIONAL AND LOCAL GOVERNMENT,
HOUSING AND RURAL DEVELOPMENT**

No. 18

2007

**KAPPSFARM TOWN PLANNING SCHEME:
TOWN PLANNING ORDINANCE, 1954**

In terms of section 26(2) of the Town Planning Ordinance, 1954 (Ordinance No. 18 of 1954), I give notice that I have under section 26(1) of that Ordinance, read with section 27(1) thereof, approved the Kappsfarm Town Planning Scheme of the Regional Council of Khomas.

**J. PANDENI
MINISTER OF REGIONAL AND LOCAL
GOVERNMENT, HOUSING AND
RURAL DEVELOPMENT**

Windhoek, 23 January 2007

**MINISTRY OF REGIONAL AND LOCAL GOVERNMENT,
HOUSING AND RURAL DEVELOPMENT**

No. 19

2007

**OTJIWARONGO TOWN PLANNING AMENDMENT SCHEME NO. 9:
TOWN PLANNING ORDINANCE, 1954**

In terms of section 26(2) of the Town Planning Ordinance, 1954 (Ordinance No. 18 of 1954), I give notice that I have under section 26(1) of that Ordinance, read with section 27(1) thereof, approved the Otjiwarongo Town Planning Amendment Scheme No. 9 of the Municipal Council of Otjiwarongo.

**J. PANDENI
MINISTER OF REGIONAL AND LOCAL
GOVERNMENT, HOUSING AND
RURAL DEVELOPMENT**

Windhoek, 27 December 2006

**MINISTRY OF REGIONAL AND LOCAL GOVERNMENT,
HOUSING AND RURAL DEVELOPMENT**

No. 20

2007

**WALVIS BAY AMENDMENT SCHEME NO. 13:
TOWN PLANNING ORDINANCE, 1954**

In terms of section 26(2) of the Town Planning Ordinance, 1954 (Ordinance No. 18 of 1954) I hereby give notice that I have under section 26(1) of that Ordinance, read with section 27(1) thereof, approved the Walvis Bay Amendment Scheme No. 13 of the Municipal Council of Walvis Bay.

**J. PANDENI
MINISTER OF REGIONAL AND LOCAL
GOVERNMENT, HOUSING AND
RURAL DEVELOPMENT**

Windhoek, 27 December 2006

General Notices

NURSING COUNCIL OF NAMIBIA

No. 18

2007

AMENDMENT OF GOVERNMENT NOTICE NO. 357 OF 24 NOVEMBER 2006

Government Notice No. 357 of 24 November 2006 is amended by the substitution for the definition of "the Act" of the following definition:

"the Act" means the Nursing Act, 2004 (Act No. 8 of 2004)."

PROFESSOR A. VAN DYK

PRESIDENT

INTERIM NURSING COUNCIL OF NAMIBIA

Windhoek, 18 January 2007

NAMIBIA FINANCIAL INSTITUTIONS SUPERVISORY AUTHORITY

No. 19

2007

IRREGULAR OR UNDESIRABLE PRACTICE

Under section 4(9) of the Medical Aid Funds Act, 1995 (Act No. 23 of 1995), I hereby declare the practice by medical aid funds of advertising themselves or their products, in whatever media format, by which members of the public are invited to take part in a competition, game show or other similar means, in terms whereof a person could win money, services, products or other rewards, should the person take part in the competition or become a member of the medical aid fund concerned, as an irregular or undesirable practice.

R. RITTER

REGISTRAR: MEDICAL AID FUNDS

Windhoek, February 2007

NATIONAL HERITAGE COUNCIL OF NAMIBIA

No. 20

2007

DECLARATION OF AN AREA TO BE A CONSERVATION AREA: NATIONAL HERITAGE ACT, 2004

- (a) Under section 54(1) of the National Heritage Act, 2004 (Act No. 27 of 2004), the National Heritage Council declares the area whose geographical boundaries are described in the Schedule and in Deed of transfer No. T935 of 1989 with the Surveyor General Diagram No. A89/87 annexed thereto, to be the Twyfelfontein conservation area.
- (b) A diagram and other information or documents referred to in paragraph (a) lie open for inspection by the public during office hours at the offices of the Director: National Heritage Council, 52 Robert Mugabe Avenue, Ausspannplatz, Windhoek and at the office of the Registrar of Deeds, Ministry of Lands and Resettlement, Robert Mugabe Avenue, Windhoek.

E.N. NAMHILA
CHAIRPERSON: NATIONAL HERITAGE
COUNCIL OF NAMIBIA

Windhoek, 29 January 2007

SCHEDULE

**DESCRIPTION OF THE GEOGRAPHICAL BOUNDARIES OF THE
TWYFELFONTEIN CONSERVATION AREA**

From point A of the annexed diagram the boundary line runs easterly to point B. From point B the boundary line runs easterly to point C. From point C the boundary line runs southward to point D. From point D the boundary line runs southerly to point E. From point E the boundary line runs southerly to point F. From point F the boundary line runs southward to point G. The boundary line runs southerly from point G to point H. From point H the boundary line runs westwards to point J. From point J the boundary line runs westerly to point K. From point K the boundary line runs northward to point L. From point L the boundary line runs northerly to the point of beginning, point A.

The co-ordinates of the geographical boundaries of the Twyfelfontein conservation area

Co-ordinates		
Point	Latitude S	Longitude E
A	-20.54147	14.31623
B	-20.5417	14.32264
C	-20.5447	14.4017
D	-20.6107	14.41938
E	-20.61451	14.42095
F	-20.62443	14.42329
G	-20.64183	14.42167
H	-20.64993	14.42092
J	-20.62821	14.34874
K	-20.59667	14.33698
L	-20.59667	14.33212

DIAGRAM

L.G.-AFSKRIF

GOEDGEKEUR

M. van der Haar

VEL NR. 2.

Nr.A. 89/87

LANDMETER-GENERAAL

1987-04-30

HIERDIE KAART BESTAAN UIT 2 VELLE

BAKENBESKRYWING:

A,B,C,D,E,

F,H,J,K,N,P 20mm Ronde ysterpen onder klipstapel

G,L,M, Gat in rots onder klipstapel

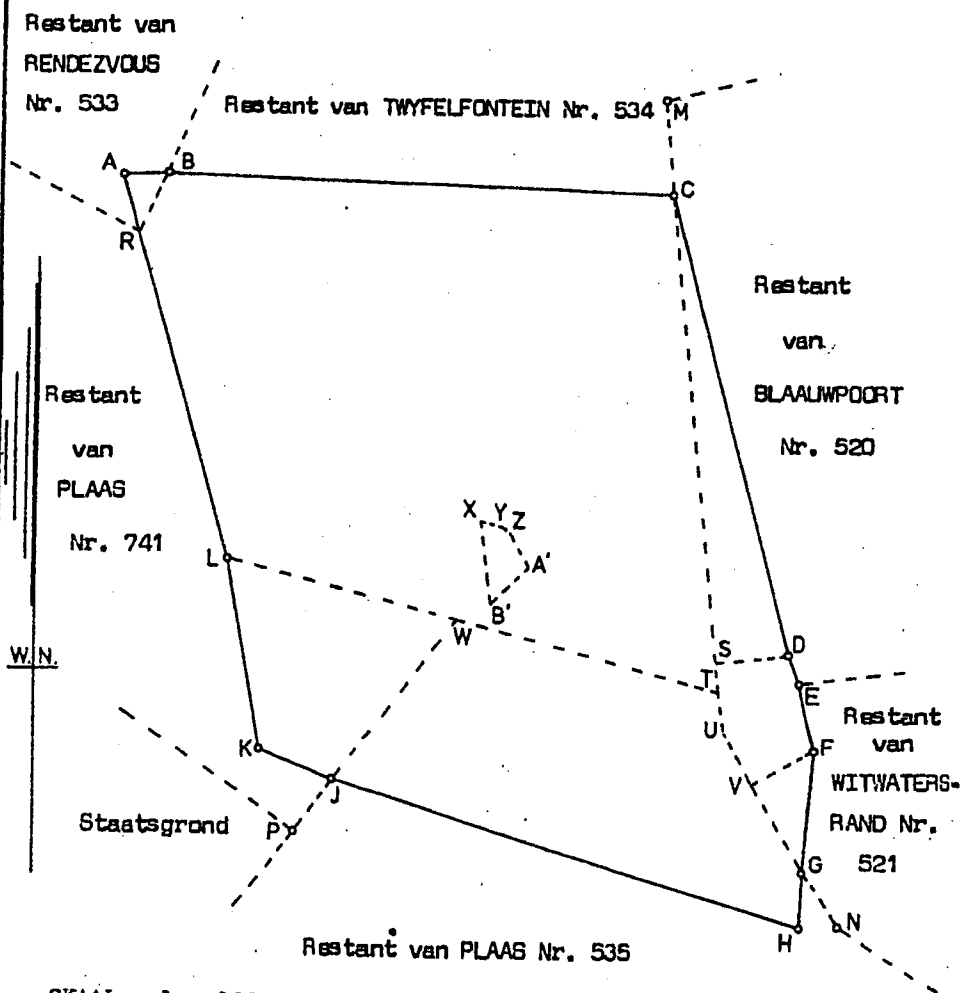
SKAAL - 1 : 100 000Opgemets in Januarie 1987, deur my.....
Landmeter

L.G.-AFSKRIF

GOEDGEKEUR

Vol. Nr.1.

Nr. A 89/87

J. LANDMETER-GENERAAL

Hierdie kaart bestaan uit 2 velle

1987-04-30

SYE Meters		RIGTINGSHOEKE " " "	KOÖRDINATE Stelsel 22/15 y x			BEN.
AB	668,89	272 04 10	A	+71 237,66	-161 390,02	AJ.1
BC	8 251,97	272 04 49	B	+70 579,20	-161 366,23	AJ.2
CD	7 536,02	345 37 49	C	+62 332,68	-161 066,67	AJ.3
DE	452,69	338 42 50	D	+60 462,41	-153 766,42	HB327
EF	1 124,24	347 16 00	E	+60 298,07	-153 344,61	HB328
FG	1 934,14	4 46 50	F	+60 050,26	-152 248,02	HB329
GH	900,42	4 47 00	G	+60 211,42	-150 320,61	AJ.5
HJ	7 898,38	107 30 26	H	+60 286,52	-149 423,32	AJ.6
JK	1 308,43	110 19 40	J	+67 819,03	-151 799,37	AJ.7
KL	3 075,20	170 17 14	K	+69 045,98	-152 253,91	AJ.8
LA	6 330,04	164 40 34	L	+69 564,80	-155 285,03	HB2468
Konneksies:						
OM	1 532,03	174 26 30	M	+62 481,07	-162 591,50	HB2460
GN	989,00	328 44 50	N	+59 698,31	-149 475,13	HB2464
JP	1 108,75	38 11 56	P	+68 504,68	-150 928,04	HB2562
			A82	+58 542,37	-146 835,04	Sengar
			A97	+77 477,24	-157 989,62	Tsarabi
			A107	+57 047,67	-163 466,86	Willem

Komponente:

1. Die figuur A B R stel voor GEDEELTE 1 van die plaas RENDEZVOUS Nr.533. Sien kaart Nr. A 83/87
2. Die figuur B C T W L R min uitgeslote figuur X Y Z A' B' stel voor GEDEELTE 1 van die plaas TWYFELFONTEIN Nr.534. Sien kaart Nr. A 84/87
3. Die figuur C D S stel voor GEDEELTE 1 van die plaas BLAAUWPOORT Nr.520. Sien kaart Nr. A 85/87
4. Die figuur S D E F V U stel voor die plaas VERBRANDEBERG Nr.72. Sien kaart Nr. A 619/56, gehag aan SGST 655/57
5. Die figuur V F G stel voor GEDEELTE 1 van die plaas WITWATERSKRAN Nr.521. Sien kaart Nr. A 86/87
6. Die figuur W T U V G H J stel voor GEDEELTE 1 van die plaas Nr.535. Sien kaart Nr. A 87/87
7. Die figuur L W J K stel voor GEDEELTE 1 van die plaas Nr.741. Sien kaart Nr. A 88/87
8. Die figuur X Y Z A' B' stel voor die plaas TWYFELFONTEIN PRE-HISTORIESE RESERVAAT Nr.722. Sien kaart Nr. A 856/56, gehag aan

Die figuur A B C D E F G H J K L
stel voor 9 194,4828 hektaar grond, synde
die plaas TWYFELFONTEIN RESERVAAT Nr. 873
geleë in die Registrasie-Afdeling A

Opgemee in Januarie 1987

deur my

Suidwes-Afr

Landme

Hierdie kaart is gehag aan
T. 935/1989 Nr.
gedateer 1989.04.12

Registrateur van Aktes

Die oorspronklike kaart is
soos hierbo aangetoon

M.S. Nr. E. 20/87
Alg. Plan Nr.
Noteerplan ODS
Lêer Nr. A.873
Breed. 20°31' Suid
Leng. 14°23' Oos

Buffer Zone Twyfelfontein Reserve (873)

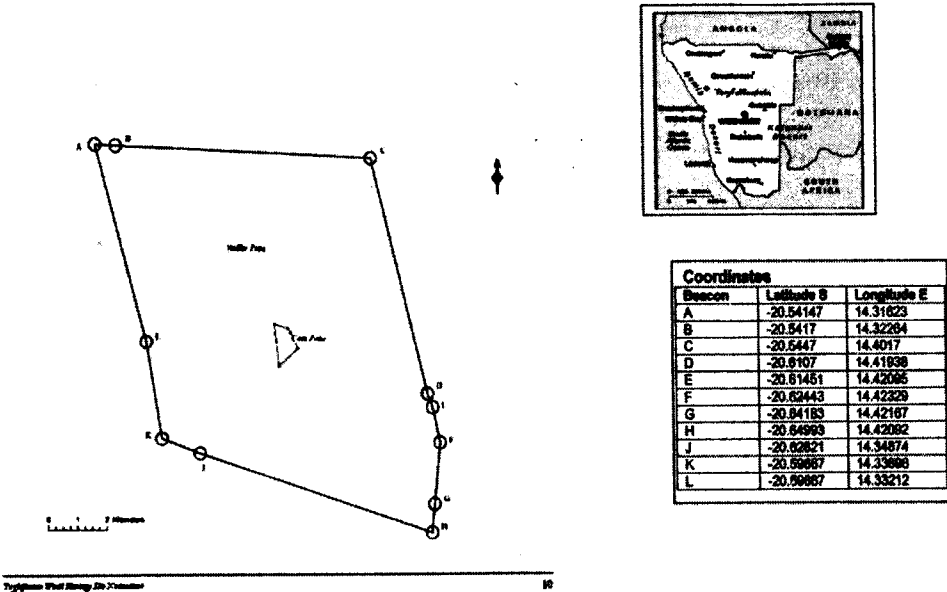

By National Heritage Council for World Site Heritage Nomination
Sources: Title Deed T935/1989 (Ref. 19/5/1/7) - Registrar of Deeds Ministry of Lands Resettlement & Rehabilitation

No. 212007

COMPILATION OF HENTIES BAY TOWN PLANNING AMENDMENT
SCHEMES NO. 7 TO 10

Notice is hereby given in terms of Section 17 of the Town Planning Ordinance No. 18 of 1954 as amended, that the Municipality of Henties Bay intends to submit for approval by Cabinet the Henties Bay Town Planning Amendment Schemes No. 7 to 10.

The Honourable Minister of Regional and Local Government and Housing has already granted approval for the compilation of the Henties Bay Town Planning Amendment Schemes which will be submitted within due course.

P.L. GURIRAB
TOWN CLERK
MUNICIPALITY OF HENTIES BAY

STAMPRIET VILLAGE COUNCIL

No. 222007

WATER SUPPLY TARIFFS, FEES AND OTHER CHARGES

Stampriet Village Council has under Section 30(1)(u) of the Local Authority Act, (Act No. 23 of 1992) determined the tariffs, fees and other charges as set out in the Schedule, with effect from 1 July 2006.

SCHEDULE

- A. DEPOSITS**
- | | |
|--------------------------|--------|
| a) Residential per month | 152-00 |
| b) All other consumers | 310-00 |

B. CONNECTION FEES

(1 m within erf boundary)

- | | |
|----------------------|-----------------------------|
| a) Residential | 310-00 |
| b) Business or other | actual cost + 15% surcharge |

Disconnection & Reconnection on request	50-00
Disconnection & Reconnection due to none payment	90-00

C. MONTHLY BASIC CHARGES

- | | |
|----------------------|--------|
| a) Residential | 27-00 |
| b) Business or other | 160-00 |

D. CONSUMPTION COST

Per 1000 litre	6-50
----------------	------

E. DETECTIVE METERS

The testing of meters is free of charge where it is found that the meter has a defect. If it is on good working order, the customer must pay the actual cost of the rest.

Bypass of the meter, sabotage or tempering etc.	2000-00 + legal costs & water usage
---	-------------------------------------

F. SITE RENT

Residential shack per month for 300m	20-00
Residential shack with Shebeen per month	30-00
Use of public open space per day	27-00

G. SEWERAGE BASIC CHARGES (WATERBORNE SEWERAGE)

- | | |
|--------------------------------|-------|
| a) Residential per month | 27-00 |
| b) Business or other per month | 65-00 |

H. SEWERAGE DISCHARGE PER MONTH (WATERBORNE SEWERAGE)

- | | |
|---|-------|
| a) Residential per toilet per month | 27-00 |
| b) Business or other per toilet per month | 65-00 |

I. NEW SEWERAGE CONNECTIONS

- | | |
|----------------|--------|
| a) Residential | 310-00 |
| b) Business | 620-00 |

J. SEWERAGE SUMPS

Removal per load or part thereof	50-00
Removal outside scheme area per kilometer	15-00 + actual cost

K. NIGHT SOIL REMOVAL

Removal per bucket per month	27-00
------------------------------	-------

L. HOUSEHOLD REFUSE REMOVAL

Residential per standard receptacle (bin) per month	27-00
Business per standard receptacle per month	110-00
Business per non-standard receptacle per month	130-00
Illegal refuse dumping	500-00

M. OTHER WASTE REMOVALS

Garden waste per load	60-00
Building rubbles, special domestic waste or other per load	110-00
Cutting and removal of trees	
Small trees or bushes	80-00
Big trees	100-00

N. HOUSE RENT

Single Quarter and flats per month	260-00
Alienation houses	60-00

O. CEMETERY

<u>Town</u>	
Masonry grave	2100-00
Normal grave	1100-00

<u>Soetdoringlaagte</u>	
Pensioners (60 yrs.), Disable and Children under 18 years	60-00
Adults (from 18 yrs. and above)	100-00

P. DOG TAX

Gelding dog & Spayed bitch per annum	60-00
Un-spayed bitch per annum	80-00

Q. POUNDAGE

Small stock per head per month	3-70
Large stock per head per month	6-80
Lease of Grazing camps per month	300-00

R. FITNESS CERTIFICATES

Hawkers per annum	120-00
Peddlers per annum	120-00
Businesses	200-00
Business registration per annum	200-00
Business inspection per annum	20-00
Issuing of Clearance or Valuation certificate	50-00

S. BUILDING PLAN

<u>Building plan per square meter</u>	
Residential	2-00
Business	6-50

Boundary Wall	0-80
Submission of Building Plans	50-00
Illegal construction without Council approval	2000-00

T. OTHER CHARGES

Sand	
Sand per load	90-00
Sand for Business per load	100-00
Stones	
Stones per m ²	200-00

BY ORDER OF THE COUNCIL

H. !GAOSEB
CHAIRPERSON

STAMPRIET VILLAGE COUNCIL

No. 23

2007

LEVYING OF RATES AND RATEABLE PROPERTY

The Village Council of Stampriet has under Section 73(1) of the Local Authorities Act of 1992 (Act No. 23 of 1992) as amended, determines the rates payable in respect of the rateable properties for the period 1 July 2006 to 30 June 2007 as follow.

SCHEDULE**1. ASSESSMENT RATES**

Residential	
On Site/Land value - Soetdoringlaagte	0,0635
On Site/Land value - Town	0,079
On improvement - All	0,0020
Business/others	
On land value	0,159
On improvement value	0,0050

BY ORDER OF THE COUNCIL

H. !GAOSEB
CHAIRPERSON: STAMPRIET VILLAGE COUNCIL

No. 24

2007

**PERMANENT CLOSURE OF PORTIONS A, B AND C OF ERF 2372,
ONDANGWA EXTENSION 4 AS PUBLIC OPEN SPACE**

Notice is hereby given in terms of Article 50(3)(a)(ii) of the Local Authorities Act of 1992 (Act No. 23 of 1992) that the Ondangwa Town Council proposes to close

permanently the under-mentioned portions of Erf 2372, Ondangwa Extension 4, as indicated on the plan which lies for inspection during office hours at the Ondangwa Town Council, and also attached to the Notice Board.

**PERMANENT CLOSURE OF PORTIONS A, B AND C OF ERF 2372,
ONDANGWA EXTENSION 4 AS PUBLIC OPEN SPACE**

Objections to the proposed closing should be submitted in writing to the Chief Executive Officer within fourteen (14) days after the appearance of this notice in accordance with Article 50(3)(a)(iv) of the above Act. The final day for objections is 1 March 2007

**WINPLANcc
P.O. BOX 90761
WINDHOEK**

No. 25

2007

**PERMANENT CLOSURE OF ERF 310, OHANGWENA AS PUBLIC OPEN
SPACE AND PORTIONS A AND B OF ERF 320, OHANGWENA AS PUBLIC
OPEN SPACE**

Notice is hereby given in terms of Article 50(3)(a)(ii) of the Local Authorities Act of 1992 (Act No. 23 of 1992) that the Helao Nafidi Town Council proposes to close permanently Erf 310, Ohangwena and the under-mentioned portions of Erf 320, Ohangwena, as indicated on the plan which lies for inspection during office hours at the Helao Nafidi Town Council, and also attached to the Notice Board.

**PERMANENT CLOSURE OF ERF 310, OHANGWENA AS PUBLIC OPEN
SPACE**

**PERMANENT CLOSURE OF PORTIONS A AND B OF ERF 320,
OHANGWENA AS PUBLIC OPEN SPACE**

Objections to the proposed closing should be submitted in writing to the Chief Executive Officer within fourteen (14) days after the appearance of this notice in accordance with Article 50(3)(a)(iv) of the above Act. The final day for objections is 1 March 2007.

**WINPLANcc
P.O. BOX 90761
WINDHOEK**

No. 26

2007

**PERMANENT CLOSURE OF PORTION A OF ERF 340, OSHIKANGO AS
PUBLIC OPEN SPACE**

Notice is hereby given in terms of Article 50(3)(a)(ii) of the Local Authorities Act of 1992 (Act No. 23 of 1992) that the Helao Nafidi Town Council proposes to close permanently the under-mentioned portion of Erf 340, Oshikango, as indicated on the plan which lies for inspection during office hours at the Helao Nafidi Town Council, and also attached to the Notice Board.

PERMANENT CLOSURE OF PORTION A OF ERF 340, OSHIKANGO AS
PUBLIC OPEN SPACE

Objections to the proposed closing should be submitted in writing to the Chief Executive Officer within fourteen (14) days after the appearance of this notice in accordance with Article 50(3)(a)(iv) of the above Act. The final day for objections is 1 March 2007.

WINPLANcc
P.O. BOX 90761
WINDHOEK

**MINISTRY OF REGIONAL AND LOCAL GOVERNMENT, HOUSING
AND RURAL DEVELOPMENT**

No. 27

2007

**ESTABLISHMENT OF THE TOWNSHIPS: ENGELA-OMAFU EXTENSIONS 1
TO 4: TOWN COUNCIL OF HELAO NAFIDI**

Notice is hereby given in terms of subsection (5) of section 5 of the Townships and Division of Land Ordinance, 1963 (Ordinance 11 of 1963), as amended that application has been made for the establishment of the township **Engela-Omafo Extensions 1 to 4** situated on Portions 9 to 12 of the Farm Helao Nafidi Town and Townlands No 997 and that the application is lying open to inspection at the office of the Division Town and Regional Planning, 2nd Floor, GRN Office Park in Windhoek, the Surveyor-General in Windhoek and at the Office of the Chief Executive Officer, Town Council of Helao Nafidi.

Any person who wishes to object to the application, may submit written evidence to the Townships Board, Private Bag 13289, Windhoek: Provided that such written evidence shall reach the Secretary of the Townships Board not later than **6 April 2007**, or who is desirous of being heard or making representations at the Townships Board meeting which will be held on **10 April 2007 at 9H00 in Windhoek**.

P.D. SWART
CHAIRMAN: TOWNSHIPS BOARD

**MINISTRY OF REGIONAL AND LOCAL GOVERNMENT, HOUSING
AND RURAL DEVELOPMENT**

No. 28

2007

**ESTABLISHMENT OF THE TOWNSHIP: ZIVELI LIFESTYLE VILLAGE:
KARAS REGIONAL COUNCIL**

Notice is hereby given in terms of subsection (5) of section 5 of the Townships and Division of Land Ordinance, 1963 (Ordinance 11 of 1963), as amended that application has been made for the establishment of the township **Ziveli Lifestyle Village** situated on Portion 8 (a portion of Portion 4) of the Farm Aris No. 29 and that the application is lying open to inspection at the office of the Division Town and Regional Planning, 2nd Floor, GRN Office Park in Windhoek, the Surveyor-General in Windhoek and at the Office of the Chief Executive Officer, Karas Regional Council.

Any person who wishes to object to the application, may submit written evidence to the Townships Board, Private Bag 13289, Windhoek: Provided that such written evidence shall reach the Secretary of the Townships Board not later than **6 April 2007**, or who is desirous of being heard or making representations at the Townships Board meeting which will be held on **10 April 2007 at 9H00 in Windhoek**.

P.D. SWART

CHAIRMAN: TOWNSHIPS BOARD

**MINISTRY OF REGIONAL AND LOCAL GOVERNMENT, HOUSING
AND RURAL DEVELOPMENT**

No. 29

2007

**ESTABLISHMENT OF THE TOWNSHIPS: OSHIKANGO EXTENSIONS 2, 3, 4
AND 5: TOWN COUNCIL OF HELAO NAFIDI**

Notice is hereby given in terms of subsection (5) of section 5 of the Townships and Division of Land Ordinance, 1963 (Ordinance 11 of 1963), as amended that application has been made for the establishment of the township **Oshikango Extension 2** situated on Portion 6 of the farm Helao Nafidi Town and Townlands No. 997, **Oshikango Extension 3** situated on Portion 8 of the farm Helao Nafidi Town and Townlands No. 997, **Oshikango Extension 4** situated on Erf 1, Oshikango and **Oshikango Extension 5** situated on Erf 80, Oshikango and that the applications is lying open to inspection at the office of the Division Town and Regional Planning, 2nd Floor, GRN Office Park in Windhoek, the Surveyor-General in Windhoek and at the Office of the Chief Executive Officer, Town Council of Helao Nafidi.

Any person who wishes to object to the application, may submit written evidence to the Townships Board, Private Bag 13289, Windhoek: Provided that such written evidence shall reach the Secretary of the Townships Board not later than **6 April 2007**, or who is desirous of being heard or making representations at the Townships Board meeting which will be held on **10 April 2007 at 9H00 in Windhoek**.

P.D. SWART

CHAIRMAN: TOWNSHIPS BOARD

**MINISTRY OF REGIONAL AND LOCAL GOVERNMENT, HOUSING
AND RURAL DEVELOPMENT**

No. 30

2007

**ESTABLISHMENT OF THE TOWNSHIPS: OHANGWENA EXTENSIONS 1, 2
AND 3: TOWN COUNCIL OF HELAO NAFIDI**

Notice is hereby given in terms of subsection (5) of section 5 of the Townships and Division of Land Ordinance, 1963 (Ordinance 11 of 1963), as amended that application has been made for the establishment of the township **Ohangwena Extensions 1, 2 and 3** on Portions 13, 14 and 15 of the Farm Helao Nafidi Town and Townlands No 997 and that the application is lying open to inspection at the office of the Division Town and Regional Planning, 2nd Floor, GRN Office Park in Windhoek, the Surveyor-General in Windhoek and at the Office of the Chief Executive Officer, Town Council of Helao Nafidi.

Any person who wishes to object to the application, may submit written evidence to the Townships Board, Private Bag 13289, Windhoek: Provided that such written evidence shall reach the Secretary of the Townships Board not later than **6 April 2007**, or who is desirous of being heard or making representations at the Townships Board meeting which will be held on **10 April 2007 at 9H00 in Windhoek.**

P.D. SWART

CHAIRMAN: TOWNSHIPS BOARD

**MINISTRY OF REGIONAL AND LOCAL GOVERNMENT, HOUSING
AND RURAL DEVELOPMENT**

No. 31

2007

**ESTABLISHMENT OF THE TOWNSHIP: TSANDI EXTENSION 1:
OMUSATI REGIONAL COUNCIL**

Notice is hereby given in terms of subsection (5) of section 5 of the Townships and Division of Land Ordinance, 1963 (Ordinance 11 of 1963), as amended that application has been made for the establishment of the township **Tsandi Extensions 1** situated on Erf 1, Tsandi and that the application is lying open to inspection at the office of the Division Town and Regional Planning, 2nd Floor, GRN Office Park in Windhoek, the Surveyor-General in Windhoek and at the Office of the Chief Executive Officer, Omusati Regional Council.

Any person who wishes to object to the application, may submit written evidence to the Townships Board, Private Bag 13289, Windhoek: Provided that such written evidence shall reach the Secretary of the Townships Board not later than **6 April 2007**, or who is desirous of being heard or making representations at the Townships Board meeting which will be held on **10 April 2007 at 9H00 in Windhoek.**

P.D. SWART

CHAIRMAN: TOWNSHIPS BOARD

**MINISTRY OF REGIONAL AND LOCAL GOVERNMENT, HOUSING
AND RURAL DEVELOPMENT**

No. 32

2007

**ESTABLISHMENT OF THE TOWNSHIPS: ONUUNO AND ONUUNO
EXTENSIONS 1, 2 AND 3: TOWN COUNCIL OF HELAO NAFIDI**

Notice is hereby given in terms of subsection (5) of section 5 of the Townships and Division of Land Ordinance, 1963 (Ordinance 11 of 1963), as amended that application has been made for the establishment of the township **Onuuno and Onuuno Extensions 1, 2 and 3** on Portions 16, 17, 18 and 19 of the Farm Helao Nafidi Town and Townlands No 997 and that the application is lying open to inspection at the office of the Division Town and Regional Planning, 2nd Floor, GRN Office Park in Windhoek, the Surveyor-General in Windhoek and at the Office of the Chief Executive Officer, Town Council of Helao Nafidi.

Any person who wishes to object to the application, may submit written evidence to the Townships Board, Private Bag 13289, Windhoek: Provided that such written evidence

shall reach the Secretary of the Townships Board not later than **6 April 2007**, or who is desirous of being heard or making representations at the Townships Board meeting which will be held on **10 April 2007 at 9H00 in Windhoek.**

P.D. SWART

CHAIRMAN: TOWNSHIPS BOARD

**MINISTRY OF REGIONAL AND LOCAL GOVERNMENT, HOUSING
AND RURAL DEVELOPMENT**

No. 33

2007

**ESTABLISHMENT OF THE TOWNSHIP: TSEIBLAAGTE EXTENSION 5:
MUNICIPAL COUNCIL OF KEETMANSHOOP.**

Notice is hereby given in terms of subsection (5) of section 5 of the Townships and Division of Land Ordinance, 1963 (Ordinance 11 of 1963), as amended that application has been made for the establishment of the township **Tseiblaagte Extension 5** situated on Portion 91 of the Remainder of the Farm Keetmanshoop Townlands No. 150 and that the application is lying open to inspection at the office of the Division Town and Regional Planning, 2nd Floor, GRN Office Park in Windhoek, the Surveyor-General in Windhoek and at the Office of the Chief Executive Officer, Municipal Council of Keetmanshoop.

Any person who wishes to object to the application, may submit written evidence to the Townships Board, Private Bag 13289, Windhoek: Provided that such written evidence shall reach the Secretary of the Townships Board not later than **6 April 2007**, or who is desirous of being heard or making representations at the Townships Board meeting which will be held on **10 April 2007 at 9H00 in Windhoek.**

P.D. SWART

CHAIRMAN: TOWNSHIPS BOARD

No. 34

2007

KEETMANSHOOP TOWN PLANNING AMENDMENT SCHEME NO. 7

Notice is hereby given in terms of Section 23 of the Town Planning Ordinance 1954, (Ordinance 18 of 1954), as amended, that the Keetmanshoop Town Planning Amendment Scheme No. 7, has been submitted to the Minister of Regional and Local Government, Housing and Rural Development for approval.

Copies of the Keetmanshoop Town Planning Amendment Scheme No. 7 and the maps, plans, documents and other relevant matters are lying for inspection during office hours at the Municipality of Keetmanshoop and also at the Namibia Planning Advisory Board (NAMPAB), Ministry of Regional and Local Government, Housing and Rural Development, 2nd Floor, Room 234, GRN Office Park, Windhoek.

Any person who wishes to object to the approval of the Town Planning Scheme, should lodge objections in writing to the Secretary, Namibia Planning Advisory Board (NAMPAB), Private Bag 13289, Windhoek on / before 1 April 2007.

No. 35

2007

ONGWEDIVA TOWN PLANNING AMENDMENT SCHEME NO. 2

Notice is hereby given in terms of Section 23 of the Town Planning Ordinance 1954, (Ordinance 18 of 1954), as amended, that the Ongwediva Town Planning Amendment Scheme No. 2, has been submitted to the Minister of Regional and Local Government, Housing and Rural Development for approval.

Copies of the Ongwediva Town Planning Amendment Scheme No. 2 and the maps, plans, documents and other relevant matters are lying for inspection during office hours at the Ongwediva Town Council and also at the Namibia Planning Advisory Board (NAMPAB), Ministry of Regional and Local Government, Housing and Rural Development, 2nd Floor, Room 234, GRN Office Park, Windhoek.

Any person who wishes to object to the approval of the Town Planning Scheme, should lodge objections in writing to the Secretary, Namibia Planning Advisory Board (NAMPAB), Private Bag 13289, Windhoek on/before 1 April 2007.

No. 36

2007

WALVIS BAY TOWN PLANNING AMENDMENT SCHEME NO. 14

Notice is hereby given in terms of Section 23 of the Town Planning Ordinance 1954, (Ordinance 18 of 1954), as amended, that the Walvis Bay Town Planning Amendment Scheme No. 14, has been submitted to the Minister of Regional and Local Government, Housing and Rural Development for approval.

Copies of the Walvis Bay Town Planning Amendment Scheme No. 14 and the maps, plans, documents and other relevant matters are lying for inspection during office hours at the Municipality of Walvis Bay and also at the Namibia Planning Advisory Board (NAMPAB), Ministry of Regional and Local Government, Housing and Rural Development, 2nd Floor, Room 234, GRN Office Park, Windhoek.

Any person who wishes to object to the approval of the Town Planning Scheme, should lodge objections in writing to the Secretary, Namibia Planning Advisory Board (NAMPAB), Private Bag 13289, Windhoek on or before 1 April 2007.

No. 37

2007

WALVIS BAY TOWN PLANNING AMENDMENT SCHEME NO. 15

Notice is hereby given in terms of Section 23 of the Town Planning Ordinance 1954, (Ordinance 18 of 1954), as amended, that the Walvis Bay Town Planning Amendment Scheme No. 15, has been submitted to the Minister of Regional and Local Government, Housing and Rural Development for approval.

Copies of the Walvis Bay Town Planning Amendment Scheme No. 15 and the maps, plans, documents and other relevant matters are lying for inspection during office hours at the Municipality of Walvis Bay and also at the Namibia Planning Advisory Board (NAMPAB), Ministry of Regional and Local Government, Housing and Rural Development, 2nd Floor, Room 234, GRN Office Park, Windhoek.

Any person who wishes to object to the approval of the Town Planning Scheme, should lodge objections in writing to the Secretary, Namibia Planning Advisory Board (NAMPAB), Private Bag 13289, Windhoek on or before 1 April 2007.

No. 38

2007

SWAKOPMUND TOWN PLANNING AMENDMENT SCHEME NO. 27

Notice is hereby given in terms of Section 23 of the Town Planning Ordinance 1954, (Ordinance 18 of 1954), as amended, that the Swakopmund Town Planning Amendment Scheme No. 27, has been submitted to the Minister of Regional and Local Government and Housing for approval.

Copies of the Swakopmund Town Planning Amendment Scheme No. 27 and the maps, plans, documents and other relevant matters are lying for inspection during office hours at the Municipality of Swakopmund and also at the Namibia Planning Advisory Board (NAMPAB), Ministry of Regional and Local Government, Housing and Rural Development, 2nd Floor, Room 234, GRN Office Park, Windhoek.

Any person who wishes to object to the approval of the Town Planning Scheme, should lodge objections in writing to the Secretary, Namibia Planning Advisory Board (NAMPAB), Private Bag 13289, Windhoek on/before 1 April 2007.

GOCHAS VILLAGE COUNCIL

No. 39

2007

WATER SUPPLY TARIFFS AND CHARGES

The Gochas Village Council has under section 30(1)(u) of the Local Authorities Act, 1992 (Act No. 23 of 1992) as amended determined that the tariffs and charges for the supply of water as set out in the Schedule, with effect from 01 January 2007.

Schedule

Tariff N\$

A. DEPOSITS

(a) Residential customers	93.25
(b) All other customers	248.65

B. CONNECTION FEES

(1m within erf boundary)

(a) Residential (20mm standard kent optima meter)	373.00
(b) Business (50mm)	Actual cost + 15%
(c) Prepaid Meter	2,070.00
(d) Tokens	110.00

C. MONTHLY BASIC CHARGES - CONVENTIONAL

(a) Residential	21.15
(b) Business	64.65

D. CONSUMPTION COST - CONVENTIONAL

(a) Per 1000 litre - Conventional	10.90
(b) Pre-paid	10.90
(c) Standpipe	14.56
(d) 5000 - 5500	9.69
(e) 5501 - 6000	9.38
(f) 6001 -	9.05

E. DEFECTIVE METERS

The testing of meters are free of charge where it is found that the meter has a defect. If found in sound order, the customer must pay the actual cost of the test.

BY ORDER OF GOCHAS VILLAGE COUNCIL

S. ASSEGAAI
CHAIRPERSON OF THE COUNCIL

GOCHAS VILLAGE COUNCIL

No. 40

2007

SEWERAGE AND REFUSE REMOVAL TARIFFS AND CHARGES

The Gochas Village Council has under section 30(1)(u) of the Local Authorities Act, 1992 (Act No. 23 of 1992) as amended determined the Sewerage and Refuse Removal Tariffs and Charges as set out in the Schedule, with effect from 1 January 2007

SCHEDULE**A. SEWERAGE CHARGES BASIC CHARGES (Waterborne Sewerage)**

(a) Residential per month	7.75
(b) Business per month	13.25

B. SEWERAGE DISCHARGE PER MONTH (WATERBORNE SEWERAGE)

(a) Residential (for each toilet)	7.75
(b) Business per month	13.25

C. NEW SEWERAGE CONNECTIONS

(a) Residential	262.25
(b) Business	Actual cost + 15% Surcharges

D. SEWERAGE SUMPS

(a) Removal per 8000 liters or part thereof	27.60
---	-------

E. NIGHT SOIL REMOVAL

(b) Removal per bucket per month	13.25
----------------------------------	-------

F. REFUSE REMOVAL

(a) Removal per standard receptacle per month	16.55
(b) Garden refuse per load	27.60
(c) Building rubble	27.60

BY ORDER OF GOCHAS VILLAGE COUNCIL**S. ASSEGAAI****CHAIRPERSON OF THE COUNCIL****GOCHAS VILLAGE COUNCIL**

No. 41

2007

ELECTRICITY SUPPLY TARIFFS AND CHARGES

The Gochas Village Council has under section 30(1)(u) of the Local Authorities Act, 1992, (Act No. 23 of 1992) determined the tariffs and charges for the supply of electricity as set out in the Schedule, with effect from 01 January 2007.

SCHEDULE**1. CONVENTIONAL METERING****A. DEPOSITS**

(a) Small customers - Single phase	
(i) Single Phase	254.10
(b) All other customers - Single phase	
(i) Single Phase	363.00
(ii) Three Phase	786.50

B. CONNECTION FEES

(a) Small customers (Residential)	
(i) Single Phase (Up to 60 Amp)	
to cover costs of material, transport and labour	Actual cost + 15%
(ii) Three phase (Cable sizes up to 16mm ²)	
To cover costs of material, transport and labour	Actual cost + 15%
(b) All other customers	
(more than 60 Amp, 3 phase)	Actual cost + 15%

C. MONTHLY BASIC CHARGES

(a) Small customers (Residential) (Up to 60 Amp) Single phase ECB Levy	2.38 per amp circuit breaker x 1 2.38 0.0045
(b) Large customers (Business) Three phase ECB Levy	3.78 per Amp circuit breaker x 1 3.78 0.0045
(c) Customers above 60 Amp ECB Levy	3,78 per Amp circuit breaker x 3 3.78 0.0045
N\$ 65.00 per month for every kVa according to maximum demand meter. If a meter register less 40 kVa in a given month, the customer shall be assessed as if a demand of 40kVa was delivered	N\$ 78.00 per kVa plus units used according to the three phase meters plus basic monthly charges

D. ENERGY CHARGES (TARIFFS PER KWH UNIT)

(a) Small customers	0.62
(b) Large customers (Customers with maximum demand meter installations only)	0.45

E. EXTRA COSTS (ALL CUSTOMERS)

Disconnecting charge	114.95
Reconnection charge	114.95

2. PRE-PAYMENT METERING**A. CONNECTION FEES**

(a) Single phase pre-paid customers	1,028.50
(b) Three phase connection	Actual cost + 15%

B. EXTRA COST (ALL PRE-PAID METER CUSTOMERS)

Reconnection	114.95
--------------	--------

C. ENERGY CHARGES (TARRIFS PER KWH UNIT)

All pre-paid meter customers	0.67
------------------------------	------

D. READIBOARD INSTALLATIONS

Readiboard Installations, (without the meter) whereby no house reticulation is involved, will be subjected to an extra costs of:	485.00
--	--------

BY ORDER OF GOCHAS VILLAGE COUNCIL

S. ASSEGAAI
CHAIRPERSON OF THE COUNCIL

GOCHAS VILLAGE COUNCIL

No. 42

2007

BURIAL FEES, RATES AND TAXES AND GRAZING FEES

The Village Council of Gochas has under section 30(1)(u) of the Local Authorities Act, 1992 (Act No. 23 of 1992) as amended determined the charges of the Burial fees, Rates, Taxes and Grazing fees as set out in the Schedule, with effect from 1 January 2007.

SCHEDULE**4. BURIAL FEES**

(a) Area 01	1.50
(b) Area 02	52.10
(c) Area 03	168.00
(d) Build out	472.50

5. RATES & TAXES

(a) Customers	0.12
(b) Business	0.22

6. GRAZING FEES

(a) Cattle	15.00 head per month
(b) Donkeys and Horses	15.00 head per month
(c) Sheep and goat	2.00 head per month

BY ORDER OF GOCHAS VILLAGE COUNCIL

S. ASSEGAAI
CHAIRPERSON OF THE COUNCIL

OMAHEKE REGIONAL COUNCIL

No. 43

2007

SCHEDULE OF APPROVED TARIFFS (2006/2007)

TARIFF	AMOUNT
<i>LARGE POWER USERS</i>	
Basic Charge	N\$ 138.00
Charge per Unit	N\$ 0.274/kWh
ECB levy	N\$ 0.0045/kWh
Demand Charge	N\$ 85.00
70% declared maximum demand payable	

BUSINESS THREE PHASE	
Basic Charge	N\$ 6.08/Ampere
Charge per unit	N\$ 0.3842/kWh
ECB Levy	N\$ 0.0045/kWh
BUSINESS SINGLE PHASE	
Basic Charge	N\$ 1.16/Ampere
Charge per unit	N\$ 0.4520/kWh
ECB Levy	N\$ 0.0045/kWh
PRE-PAYMENT METERS	
Charge per unit	N\$ 0.52/kWh
ECB Levy	N\$ 0.0045/kWh
BUSINESS PRE-PAYMENT METERS	
Charge per unit	N\$ 0.60/kWh
ECB Levy	N\$ 0.0045/kWh
DOMESTIC	
Basic Charge	N\$ 1.20/Ampere
Charge per unit	N\$ 0.4147/kWh
ECB Levy	N\$ 0.0045/kWh
STREETLIGHTS	
Charge per unit	N\$ 0.566/kWh
ECB Levy	N\$ 0.0045/kWh
1 x 25 watt m/v street light cost/month	N\$ 26.40

New Water Tariffs

Price per Unit - m³

	Namwater tariffs	Add 10%	Add 15% VAT	New tariffs
Charges per m ³	6.97	7.67	8.82	8.82

**The Current basic charges will be increased with 10%.
Basic Charges**

Businesses N\$ 90.00 x 10% = N\$ 99.00

Residential N\$ 26.00 x 10% = N\$ 28.60

Churches N\$ 90.00 x 10% = N\$ 99.00

Water Flat Rate Tariffs for Houses without Meters will Remain the Same

Type of Water Supply	Typical Consumption	Range
COMMUNAL WATER POINT		
Standpipe at on considerable distance (> 100m)	7	5-10
Standpipe at medium distance (250-1000 m)	12	10-12
Standpipe at nearby (< 250)	30	20-50
Yard Connection	40	20-80
House connection		
Single tap	50	30-60
Multiple tap	150	70-250

MUNICIPALITY OF WINDHOEK

No. 44

2007

AMENDMENT OF WATER SUPPLY REGULATIONS

Under section 94(1) of the Local Authorities Act, 1992 (Act No. 23 of 1992), and after consultation with the Minister of Regional and Local Government, Housing and Rural Development, the Council of the Municipality of Windhoek amends the Water Supply Regulations promulgated under General Notice No. 367 of 16 December 1996, as set out in the Schedule.

SCHEDULE

Definitions

1. In these regulations, "the Regulations" means the Water Supply Regulations promulgated under General Notice No. 367 of 16 December 1996, as amended by General Notice No. 151 of 1 July 1997.

Amendment of regulation 1 of the Regulations

2. Regulation 1 is amended by the insertion after paragraph (d) of the definition of "occupier" of the following closing paragraph:

"(e) and includes the owner, whenever an occupier is in arrear with the payment of any of the charges, fees or other moneys leviable under section 30(1)(u) of the Act."

Amendment of regulation 3 of the Regulations

3. Regulation 3 is amended by the insertion after paragraph (b) of subregulation (1) of the following paragraph.

"(c) the owner or occupier of such premises -

- (i) has paid or has made acceptable arrangements for the payment of all arrear rates leviable in respect of such premises in terms of the Act; and
- (ii) has paid all the fees, charges or other moneys due to the Council in respect of any service, amenity or facility supplied to the premises in terms of the Act, inclusive of any availability charge or minimum charge leviable under section 30(1)(u) of the Act, whether it relates to a service rendered in terms of this regulation or not.”.

Amendment of regulation 4 of the Regulations

4. Regulation 4 is amended -

- (a) by the substitution for paragraph (b) of subregulation (3) of the following paragraph:
 - “(b) ensure the payment to the Council of the arrears, if any, as set out in subregulation 3(1)(c) and pay to the Council the appropriate fee determined in the electricity tariff for an initial connection, or a reconnection of the supply of electricity, whichever may be applicable.”;
- (b) by the substitution for subregulation (4) of the following subregulation:
 - “(4) made and an undertaking signed by such owner whereby the owner undertakes to acquaint himself or herself every month to ensure that any consumer account of such applicant has been fully paid in terms of the Act.”.

Amendment of regulation 20 of the Regulations

5. Regulation 20 is amended -

- (a) by the substitution for subregulation (1) of the following subregulation:
 - “(1) If an account rendered by the Council in respect of -
 - (i) the supply of electricity,
 - (ii) rates leviable in respect of such premises in terms of the Act, or
 - (iii) the fees, charges or other moneys due to the Council in respect of any service, amenity or facility supplied to the premises in terms of the Act, inclusive of any availability charge or minimum charge leviable under section 30(1)(u) of the Act, whether it relates to a service rendered in terms of these regulations or not,

is not paid by a consumer before the expiry of the last day for such payment specified in the account, the Council may forthwith suspend the supply of electricity to such consumer until the amount due is paid by the consumer, together with the charges referred to in subregulation (3).”;

(b) by the substitution for subregulation (3) of the following subregulation:

“(3) If the supply of electricity to any premises is suspended under subregulation (1) or (2), the consumer concerned shall, before such supply is restored by the Council -

- (a) pay the charges determined for suspension of the supply of electricity and for the restoration of such supply; and
- (b) pay or make acceptable arrangements for the payment of arrear rates or the fees, charges or other moneys due to the Council in respect of any service, amenity or facility supplied to premises in terms of the Act, inclusive of any availability charge or minimum charge leviable under section 30(1)(u) of the Act, whether it relates to a service rendered in terms of this regulation or not.”.

M.K. SHIKONGO
CHAIRPERSON OF THE COUNCIL
BY ORDER OF THE COUNCIL
