

**THE PROVINCE OF  
GAUTENG**



**DIE PROVINSIE  
GAUTENG**

# Provincial Gazette Extraordinary Buitengewone Provinsiale Koerant

Vol. 18

PRETORIA, 17 FEBRUARY 2012  
FEBRUARIE

**No. 35**

**We all have the power to prevent AIDS**

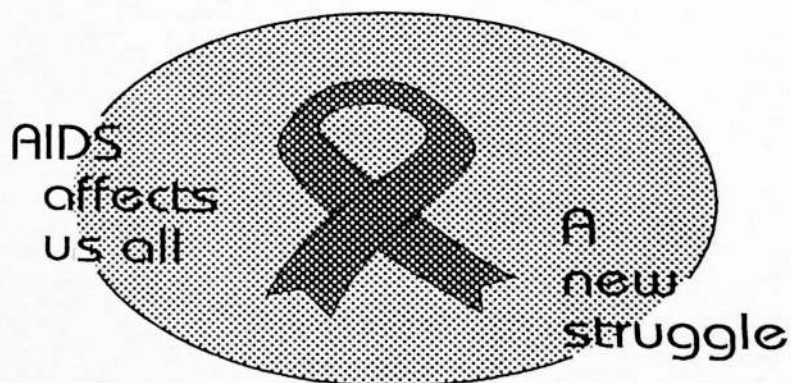

**Prevention is the cure**

**AIDS  
HELPLINE**

**0800 012 322**

DEPARTMENT OF HEALTH



**IMPORTANT NOTICE**

The Government Printing Works will not be held responsible for faxed documents not received due to errors on the fax machine or faxes received which are unclear or incomplete. Please be advised that an "OK" slip, received from a fax machine, will not be accepted as proof that documents were received by the GPW for printing. If documents are faxed to the GPW it will be the sender's responsibility to phone and confirm that the documents were received in good order.

Furthermore the Government Printing Works will also not be held responsible for cancellations and amendments which have not been done on original documents received from clients.

**CONTENTS • INHOUD**

No.

Page  
No. Gaz.

**GENERAL NOTICE**

391	Gauteng Transport Infrastructure Act (8/2001): Amendment.....	3
-----	---	---

## GENERAL NOTICE

---

### NOTICE 391 OF 2012

#### AMENDMENT OF NOTICE 295 OF 2011 IN THE PROVINCIAL GAZETTE EXTRAORDINARY NO 15 DATED 28 JANUARY 2011 IN CONNECTION WITH THE GAUTRAIN RAPID RAIL LINK

In terms of section 13 (2) of the Gauteng Transport Infrastructure Act, 2001 (Act No 8 of 2001) the MEC hereby amends Notice 295 of 2011 in the Provincial Gazette Extraordinary No 15 of 2011 dated 28 January 2011, by the substitution of the sketch plan accompanying the aforementioned notice with the accompanying sketch plan hereto.

Reference: 2/1/7/8 - Gautrain



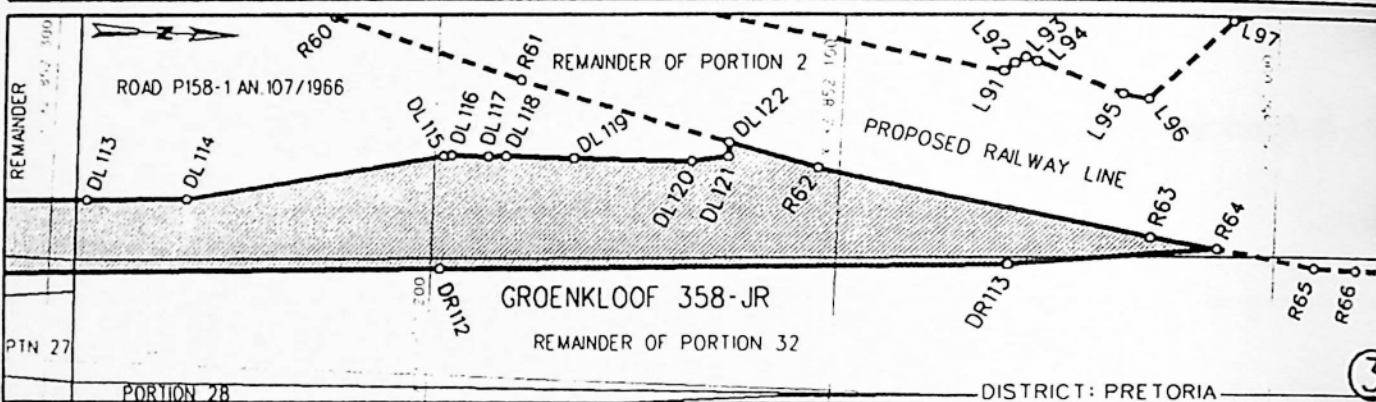
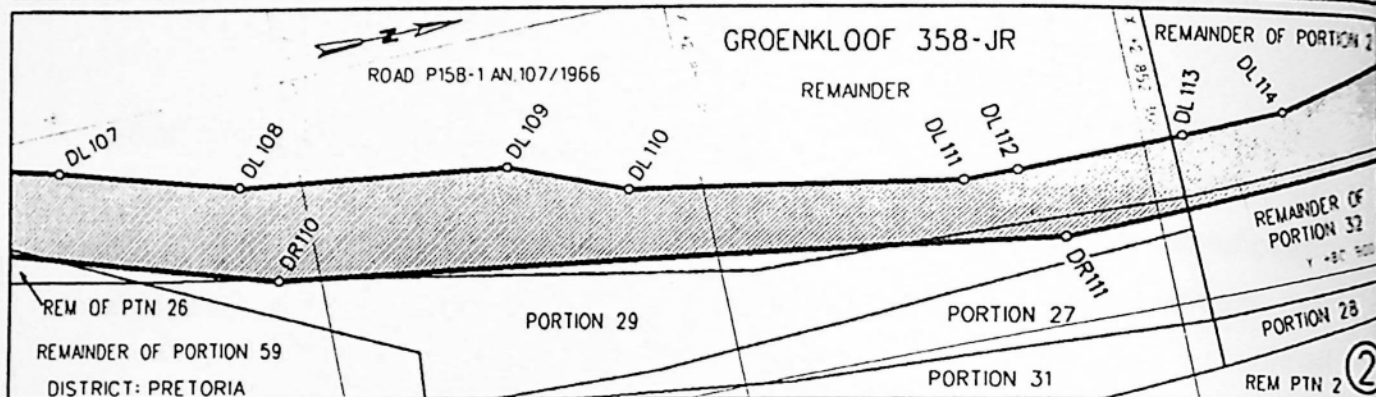
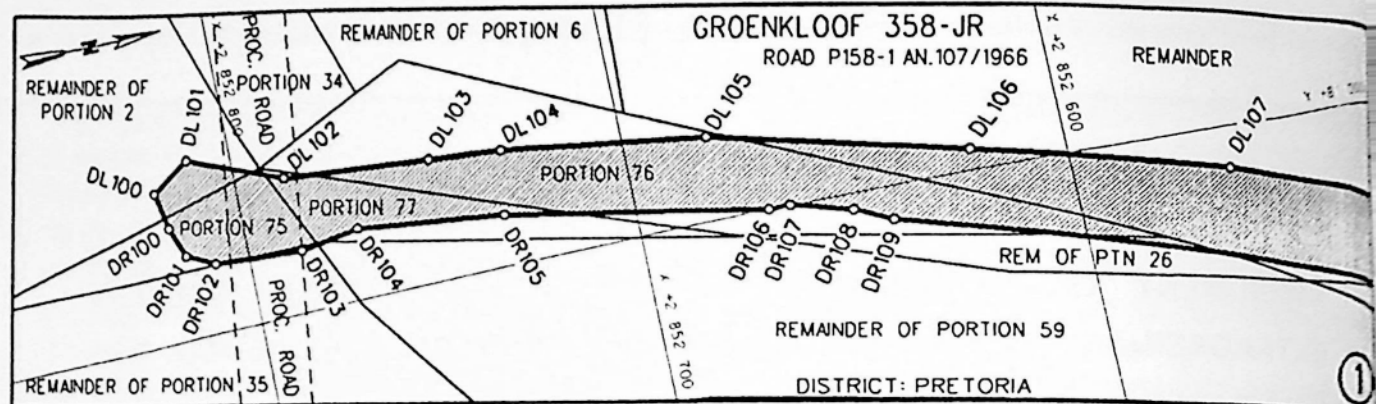

## REFERENCE

PROCLAIMED ACCESS ROAD

THE FIGURE : DL100 - DL122, R62, R63, R64, DR113 - DR100, DL100.

REPRESENTS THE PROCLAMATION OF AN ACCESS ROAD OVER PORTIONS 75, 77, 76, 29, THE REMAINDERS OF PORTIONS 2, 26, 32, 35, 59 AND THE REMAINDER OF THE FARM GROENKLOOF 358-JR AS INTENDED BY THE PUBLICATION THEREOF IN THE PROVINCIAL GAZETTE AND SHOWN IN DETAIL ON PLAN GRP 03/38/37Exp.

FILE NO. 2/1/7/8-GAUTRAIN

## CO-ORDINATE LIST WG 29° CONSTANTS. Y= +/- 0.00 X= +2 800 000.00

DL100	+81038.592	+52821.580	DL114	+80942.468	+52263.790	DR104	+81017.815	+52770.603
DL101	+81044.859	+52811.424	DL115	+80955.703	+52197.553	DR105	+81012.834	+52732.450
DL102	+81034.578	+52786.953	DL116	+80955.909	+52195.609	DR106	+80999.934	+52668.695
DL103	+81030.738	+52748.754	DL117	+80955.967	+52186.094	DR107	+80999.964	+52663.565
DL104	+81028.856	+52730.028	DL118	+80956.258	+52181.641	DR108	+80995.799	+52649.525
DL105	+81020.740	+52679.402	DL119	+80956.357	+52164.255	DR109	+80991.498	+52641.090
DL106	+81005.192	+52621.051	DL120	+80956.640	+52134.908	DR110	+80950.722	+52510.786
DL107	+80989.645	+52562.700	DL121	+80958.134	+52126.120	DR111	+80921.613	+52321.523
DL108	+80975.804	+52515.935	DL122	+80961.742	+52126.070	DR112	+80927.195	+52197.573
DL109	+80966.039	+52446.846				DR113	+80933.330	+52061.343
DL110	+80954.204	+52417.975	DR100	+81029.049	+52819.439			
DL111	+80940.067	+52340.833	DR101	+81021.134	+52816.181	R62	+80956.096	+52104.925
DL112	+80940.090	+52328.688	DR102	+81017.408	+52808.721	R63	+80941.267	+52030.098
DL113	+80941.383	+52290.447	DR103	+81015.552	+52786.076	R64	+80939.014	+52014.316