



LIMPOPO PROVINCE
LIMPOPO PROVINSIE
XIFUNDZANKULU XA LIMPOPO
PROFENSE YA LIMPOPO
VUNDU LA LIMPOPO
IPHROVINSI YELIMPOPO

**Provincial Gazette • Provinsiale Koerant • Gazete ya Xifundzankulu
Kuranta ya Profense • Gazethe ya Vundu**

(Registered as a newspaper) • (As 'n nuusblad geregistreer)

(Yi rhijistariwile tanihi Nyuziphepha)

(E ngwadisitšwe bjalo ka Kuranta)

(Yo redzhistariwa sa Nyusiphepha)

POLOKWANE,

Vol. 21

Extraordinary

**Ku katsa na Tigazete to
Hlawuleka hinkwato**

25 FEBRUARY 2014
25 FEBRUARIE 2014
25 NYENYENYANA 2014
25 FEBREWARE 2014
25 LUHUHI 2014

No. 2319

Buitengewoon

**Hu tshi katelwa na
Gazethe dza Nyingo**

We all have the power to prevent AIDS

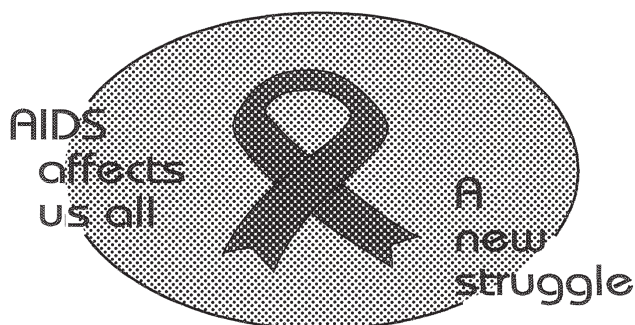

Prevention is the cure

**AIDS
HELPLINE**

0800 012 322

DEPARTMENT OF HEALTH

*N.B. The Government Printing Works will
not be held responsible for the quality of
"Hard Copies" or "Electronic Files"
submitted for publication purposes*



IMPORTANT NOTICE

The Government Printing Works will not be held responsible for faxed documents not received due to errors on the fax machine or faxes received which are unclear or incomplete. Please be advised that an "OK" slip, received from a fax machine, will not be accepted as proof that documents were received by the GPW for printing. If documents are faxed to the GPW it will be the sender's responsibility to phone and confirm that the documents were received in good order.

Furthermore the Government Printing Works will also not be held responsible for cancellations and amendments which have not been done on original documents received from clients.

CONTENTS • INHOUD*No.**Page
No. Gazette
No.***PROVINCIAL NOTICE**

- | | | | |
|---|---|---|------|
| 1 | National Environmental Management: Protected Areas Act (57/2003): Intention to declare the farms as Nature Reserve (Happy Rest Nature Reserve)..... | 3 | 2319 |
|---|---|---|------|
-

PROVINCIAL NOTICE

No. 1

25 February 2014

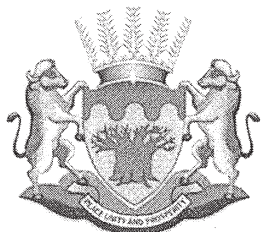

LIMPOPO
PROVINCIAL GOVERNMENT
REPUBLIC OF SOUTH AFRICA

**DEPARTMENT OF
ECONOMIC DEVELOPMENT, ENVIRONMENT & TOURISM**

LIMPOPO PROVINCIAL GOVERNMENT

DEPARTMENT OF ECONOMIC DEVELOPMENT ENVIRONMENT AND TOURISM

DECLARATION OF LAND PARCELS AS NATURE RESERVES

INTENTION TO DECLARE THE FARMS AS NATURE RESERVE (HAPPY REST NATURE RESERVE)

I, Seaparo Sekoati, Member of the Executive Council for Economic Development Environment and Tourism, hereby declare by virtue of the powers vested in me under section 23(1) (a) (i) of the National Environmental Management: Protected Areas Act, 2003 (Act No. 57 of 2003) the properties listed in the schedules as nature reserves.

I hereby invite members of the public to submit written representations to the proposed notice within 60 days from the date of this notice, by submitting it to the following address:

SEAPARO SEKOATI, MPL

MEC FOR ECONOMIC DEVELOPMENT, ENVIRONMENT AND TOURISM

Eviridiki Towers, 20 Hans van Rensburg Street, POLOKWANE, 0700, Private Bag X9484, POLOKWANE, 0700
Tel: 015 293 8300, Fax: 015 293 8319, website: <http://www.Limpopo.gov.za>

The heartland of southern Africa – development is about people!

SCHEDULE 1 (WELGEVONDEN PRIVATE NATURE RESERVE)

1. Portion 1 of the farm **WELGEVONDEN No 470**

Registration Division **KQ**, Limpopo Province

2. Portion 2 of the farm **WELGEVONDEN No.470**

Registration Division **KQ**, Limpopo Province

3. Portion 3 of the farm **WELGEVONDEN No.470**

Registration Division **KQ**, Limpopo Province

4. Portion 4 of the farm **WELGEVONDEN No.470**

Registration Division **KQ**, Limpopo Province

5. Portion 5 of the farm **WELGEVONDEN No.470**

Registration Division **KQ**, Limpopo Province

6. Portion 6 of the farm **WELGEVONDEN No.470**

Registration Division **KQ**, Limpopo Province

7. Portion 9 of the farm **WELGEVONDE No.470**

Registration Division **KQ**, Limpopo Province

8. Portion 10 of the farm **WELGEVONDEN No.470**

Registration Division **KQ**, Limpopo Province

9. *Portion 11 of the farm* **WELGEVONDEN No.470**

Registration Division **KQ**, Limpopo Province

10. *Portion 12 of the farm* **WELGEVONDEN No.470**

Registration Division **KQ**, Limpopo Province

11. *Portion 13 of the farm* **WELGEVONDEN No.470**

Registration Division **KQ**, Limpopo Province

12. *Portion 14 of the farm* **WELGEVONDEN No.470**

Registration Division **KQ**, Limpopo Province

13. *Portion 15 of the farm* **WELGEVONDEN No.470**

Registration Division **KQ**, Limpopo Province

14. *Portion 16 of the farm* **WELGEVONDEN No.470**

Registration Division **KQ**, Limpopo Province

15. *Portion 17 of the farm* **WELGEVONDEN No.470**

Registration Division **KQ**, Limpopo Province

16. *Portion 18 of the farm* **WELGEVONDEN No.470**

Registration Division **KQ**, Limpopo Province

17. Portion 19 of the farm **WELGEVONDEN No.470**

Registration Division **KQ**, Limpopo province

18. Portion 20 of the farm **WELGEVONDEN No.470**

Registration Division **KQ**, Limpopo Province

19. Portion 21 of the farm **WELGEVONDEN No.470**

Registration Division **KQ**, Limpopo Province

20. Portion 25 of the farm **WELGEVONDEN No.470**

Registration Division **KQ**, Limpopo Province

21. Portion 26 of the farm **WELGEVONDEN No.470**

Registration Division **KQ**, Limpopo Province

22. Portion 27 of the farm **WELGEVONDEN No.470**

Registration Division **KQ**, Limpopo Province

23. Portion 28 of the farm **WELGEVONDEN No.470**

Registration Division **KQ**, Limpopo Province

24. Portion 29 of the farm **WELGEVONDEN No.470**

Registration Division **KQ**, Limpopo Province

25. Portion 31 of the farm **WELGEVONDEN No.470**

Registration Division **KQ**, Limpopo Province

26. Portion 32 of the farm **WELGEVONDEN No.470**

Registration Division **KQ**, Limpopo Province

27. Portion 33 of the farm **WELGEVONDEN No.470**

Registration Division **KQ**, Limpopo Province

28. Portion 34 of the farm **WELGEVONDEN No.470**

Registration Division **KQ**, Limpopo Province

29. Portion 35 of the farm **WELGEVONDEN No. 470**

Registration Division **KQ**, Limpopo Province

30. Portion 36 of the farm **WELGEVONDEN No.470**

Registration Division **KQ**, Limpopo Province

31. Portion 37 of the farm **WELGEVONDEN No. 470**

Registration Division **KQ**, Limpopo Province

32. Portion 39 of the farm **WOLGEVONDEN No. 470**

Registration Division **KQ**, Limpopo Province

33. Portion 40 of the farm **WELGEVONDEN No.470**

Registration Division **KQ**, Limpopo Province

34. Portion 41 of the farm **WELGEVONDEN No.470**

Registration Division **KQ**, Limpopo Province

35. Portion 42 of the farm **WOLGEVONDEN No.470**

Registration Division **KQ**, Limpopo Province

36. Portion 43 of the farm **WOLGEVONDEN No.470**

Registration Division **KQ**, Limpopo Province

37. Portion 44 of the farm **WELGEVONDEN No.470**

Registration Division **KQ**, Limpopo Province

38. Portion 45 of the farm **WELGEVONDEN No.470**

Registration Division **KQ**, Limpopo Province

39. Portion 46 of the farm **WELGEVONDEN No.470**

Registration Division **KQ**, Limpopo Province

40. Portion 47 of the farm **WELGEVONDEN No.470**

Registration Division **KQ**, Limpopo Province

41. Portion 48 of the farm **WELGEVONDEN No.470**

Registration Division **KQ**, Limpopo Province

42. Portion 49 of the farm **WELGEVONDEN No.470**

Registration Division **KQ**, Limpopo Province

43. Portion 50 of the farm **WELGEVONDEN No.470**

Registration Division **KQ**, Limpopo Province

44. Portion 51 of the farm **WELGEVONDEN No.470**

Registration Division **KQ**, Limpopo Province

45. Portion 52 of the farm **WELGEVONDEN No.470**

Registration Division **KQ**, Limpopo Province

46. Portion 53 of the farm **WELGEVONDEN No.470**

Registration Division **KQ**, Limpopo Province

47. Portion 54 of the farm **WELGEVONDEN No.470**

Registration Division **KQ**, Limpopo Province

48. Portion 55 of the farm **WELGEVONDEN No.470**

Registration Division **KQ**, Limpopo Province

49. Portion 56 of the farm **WELGEVONDEN No.470**

Registration Division **KQ**, Limpopo Province

50. Portion 57 of the farm **WELGEVONDEN No.470**

Registration Division **KQ**, Limpopo province

51. Portion 58 of the farm **WELGEVONDEN No.470**

Registration Division **KQ**, Limpopo Province

52. Portion 59 of the farm **WELGEVONDEN No.470**

Registration Division **KQ**, Limpopo Province

53. Portion 79 of the farm **WELGEVONDEN 470**

Registration Division **KQ**, Limpopo Province

54. Portion 80 of the farm **WELGEVONDEN No.470**

Registration Division **KQ**, Limpopo Province

55. Portion 82 of the farm **WOLGEVONDEN No.470**

Registration Division **KQ**, Limpopo Province

56. Portion 83 of the farm **WOLGEVONDEN No.470**

Registration Division **KQ**, Limpopo Province

57. Portion 87 of the farm **WELGEVONDEN No.470**

Registration Division **KQ**, Limpopo Province

58. Portion 91 of the farm **WELGEVONDEN No.470**

Registration Division **KQ**, Limpopo Province

59. Portion 92 of the farm **WELGRVONDEN No.470**

Registration Division **KQ**, Limpopo Province

60. The remainder of portion 1 of the farm **KLIPPLAATDRIFT No.248**

Registration Division **KQ**, Limpopo Province

61. Portion 3 of the farm **KOEDOESPOORT No.238**

Registration Division **KQ**, Limpopo Province

62. The remaining extent of portion 4 of the farm **KOEDOESPOORT No.238**

Registration Division **KQ**, Limpopo Province

63. The remainder of portion 1 of the farm **KOEDOESPOORT No.238**

Registration Division **KQ** Limpopo Provincce

64. Portion 6 of the farm **KOEDOESPOORT No.238**

Registration Division **KQ**, Limpopo Province

65. Portion 8 of the farm **KOEDOESPOORT No.238**

Registration Division **KQ**, Limpopo Province

66. The remainder of portion 5 of the farm **KOEDOESPOORT No.238**

Registration Division **KQ**, Limpopo Province

67. Portion 1 of the farm **DUIKERHOEK No.225**

Registration Division **KQ**, Limpopo Province

68. Portion 2 of the farm **DUIKERHOEK No.225**

Registration Division **KQ**, Limpopo Province

69. The remainder of the farm **DUIKERHOEK No.225**

Registration Division **KQ**, Limpopo Province

70. Portion 1 of the farm **KROMELLENBOOG No.203**

Registration Division **KQ**, Limpopo Province

71. The remainder of the farm **KROMELLENBOOG No.203**

Registration Division **KQ**, Limpopo Province

72. Portion 5 of the farm **ELANDSHOEK No.263**

Registration Division **KQ**, Limpopo Province

The **TOTAL** area is in extent of **34830.5817** hectares

SHEET 2 OF 2 SHEETS

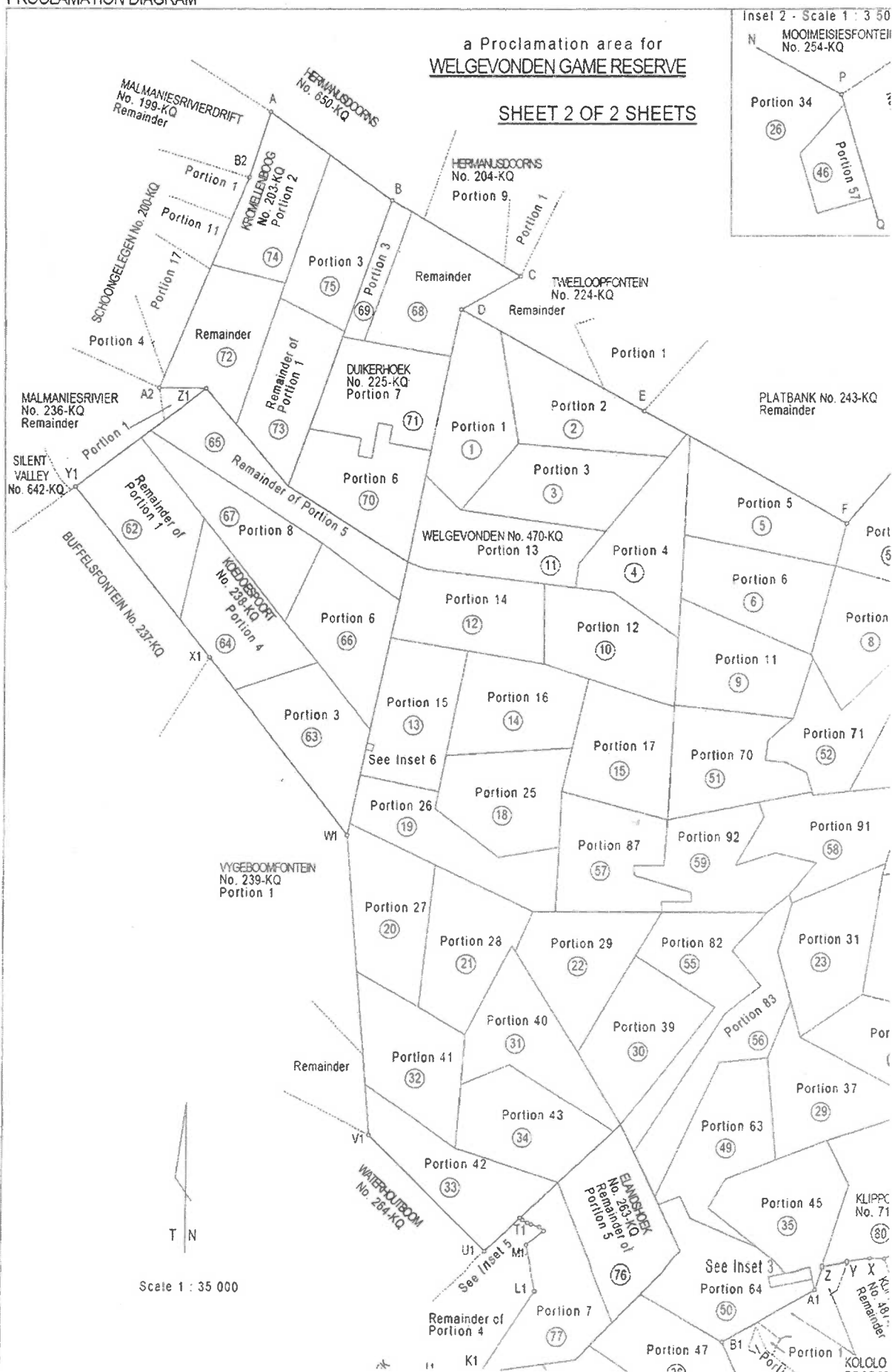

SCHEDULE 2 (LUVHONDO PRIVATE NATURE RESERVE)

1. Portion 3 of the farm **LUISVILLE 33**
Registration Division **LS**, Limpopo Province
2. Farm **LLEWELLYN 35**
Registration Division **LS**, Limpopo Province
3. Farm **ONTMOET 36**
Registration Division **LS**, Limpopo Province
4. Portion 2 of the farm **BERGPLAATS 40**
Registration Division **LS**, Limpopo Province
5. Remaining Extent of the farm **BERGPLAATS 40**
Registration Division **LS**, Limpopo Province
6. Farm **DIEPKLOOF 41**
Registration Division **LS**, Limpopo Province

TOTAL area is in extent of **4232.2117** hectares

LUVHON DO

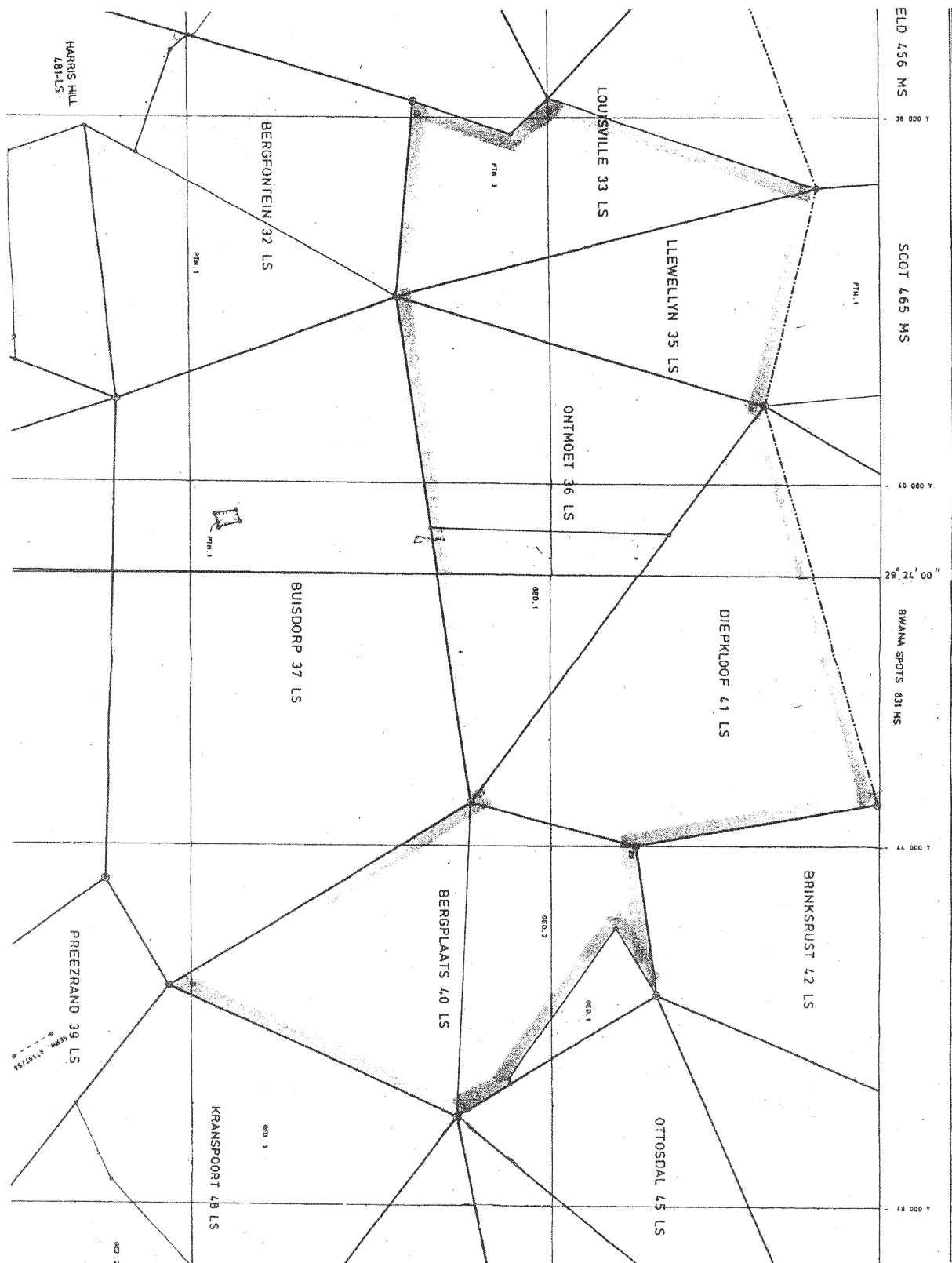

COMPOSITE PLAN

FROM SURVEYOR-GENERAL COMPILATION PLANS LSNB & LSNB

SCHEDULE 3 (MOKOLO PRIVATE NATURE RESERVE)

1. Farm **MOKOLO RIVER PRIVATE NATURE RESERVE 660**
Registration Division **KQ**, Limpopo Province,
2. Portion of Portion 6 of farm **BULGE RIVER 198**
3. Registration Division **KQ**, Limpopo Province,

DIAGRAM FOR CONSOLIDATED TITLE

OFFICE COPY

Sheet 1 of 2 Sheets

S.G. No.

8739/2002

Approved



 09.12.2002
 for
 SURVEYOR-
 GENERAL
SERVITUDE NOTE:

The line as represents the northern boundary of a
 Pipe Line Servitude 6, 30 metres wide vide diagram
 S G No a 4571/1968, Deed of Transfer No T 35029/1965.

COMPONENTS:

No	Figure	Description	Diagram S G No	Deed of Transfer No
1	1DjklmVWXYZ1A1B1C1D	The farm Manamane No 649-KQ	7664/2001	T 7817/2002
2	ab middle of Zand or Pongola Riverfeda	Remainder of the farm Hermanusdoorns No 204-KQ	A 4382/1955	T 29531/1957
3	CadcC	Portion 10 of the farm Hermanusdoorns No 204-KQ	A 4571/1968	T 35029/1965
4	ceh1Ec	Portion B of the farm Hermanusdoorns No 204-KQ	A 4390/1955	T 63/1969
5	AB1E1F1G1H1J1KA	Remainder of the farm Mooifontein 150-KQ	1850/1899	Grant 325/1916
6	DEFGHJ middle of Zand or Pongola River bD	Remainder of the farm Witfontein No 154-KQ	12275/1896	Grant 424/1868
7	KLMNPQ middle of Zand or Pongola River RSTUVmljg middle of Zand or Pongola River K	The farm Hermanusdoorns No 219-KQ	2679/1997	T 96087/1997
8	ef middle of Zand or Pongola River gjhe	Portion 7 of the farm Hermanusdoorns No 204-KQ	A 4389/1955	T 63/1969

The figure ABCDEFGHJ middle of Zand or Pongola River KLMNPQ middle
 of Zand or Pongola River RSTUVWXYZ1A1B1C1D1E1F1G1H1J1KA
 represents 6462.4337 hectares of land being
 the farm

MOKOLO RIVER PRIVATE NATURE RESERVE No 660-KQ

and comprises components 1 to 8 tabulated above

~~North-West Province~~ Northern Province

Compiled in November 2002
 by me



J. J. SNYMAN (PLS 1043)
 Professional Land Surveyor

This diagram is annexed to No. T91675/2003 d.d. i.f.o. Registrar of Deeds	The original diagrams are as tabulated above Transfer Grant	File KQ-660 S.R. G.P. Comp. KQ-2 Deeds: PRETORIA
--	--	--

(MOKOLO RIVER)

OFFICE COPY

S.G. No.

8739/2002

Approved

Ephensburg
09.12.2002

09.12.2002

for
SURVEYOR-
GENERAL

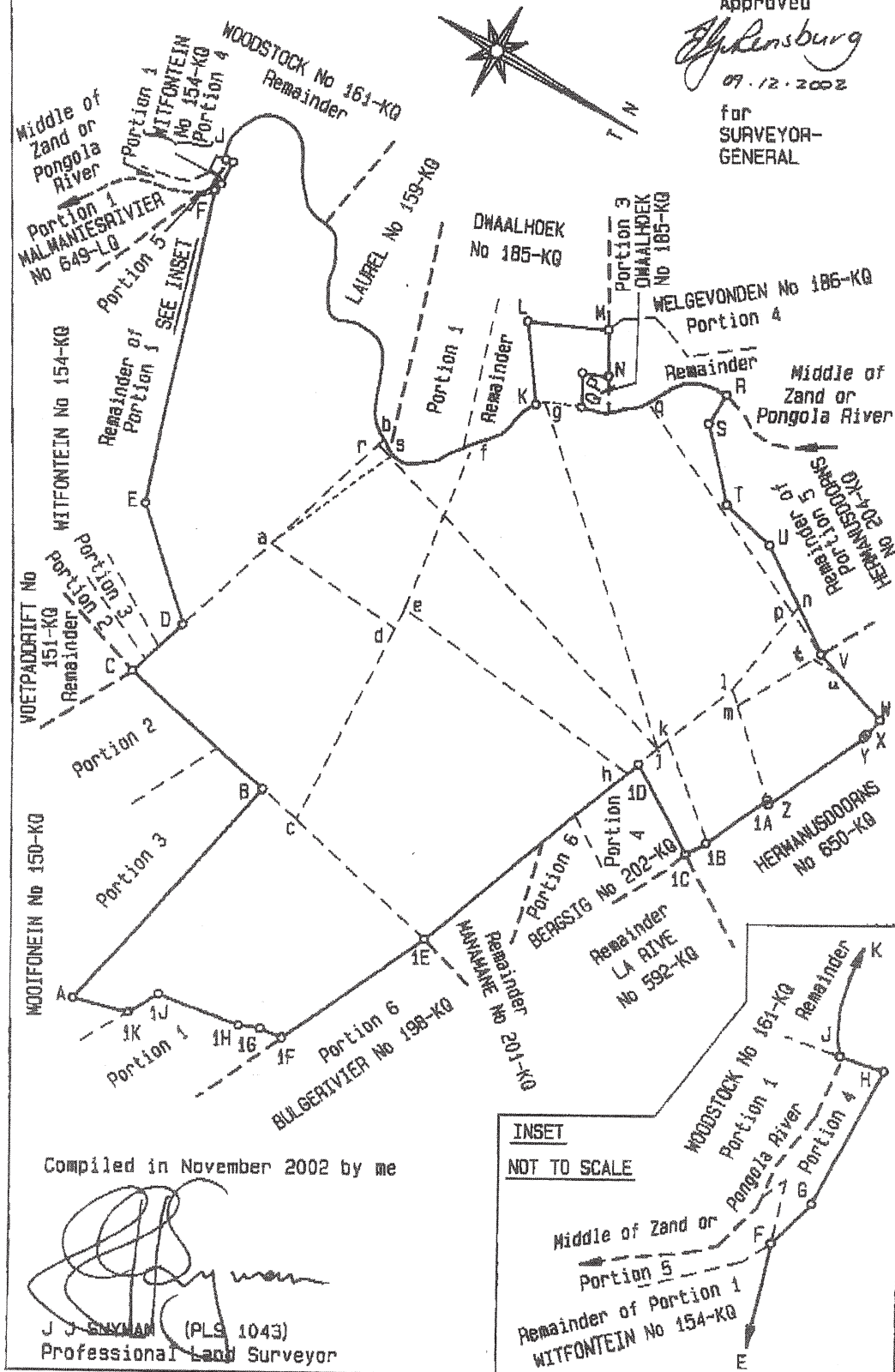

14-00000

SCHEDULE 4(HAPPY REST NATURE RESERVE)

1. The farm Mooifontein **232**
Registration Division **LS**, Limpopo Province
2. The **Remainder** of the farm Treurfontein **234**
Registration Division **LS**, Limpopo Province
3. **Portion 1** of the farm Treurfontein **234**
Registration Division **LS**, Limpopo Province
4. **Portion 2** of the farm Treurfontein **234**
Registration Division **LS**, Limpopo Province
5. **Part of the Remainder** of the farm Verzierkerf **238**
Registration Division **LS**, Limpopo Province
6. **Portion 2** of the farm Verzierkerf **238**
Registration Division **LS**, Limpopo Province
7. The **Remainder** of Happy Rest **239**
Registration Division **LS**, Limpopo Province
8. **Part of the Remainder of Portion 1** of Happy Rest **239**
Registration Division **LS**, Limpopo Province
9. **Portion 2** of the farm Bristol **241**
Registration Division **LS**, Limpopo Province
10. **Portion 2** of the farm Perth **242LS**
Registration Division **LS**, Limpopo Province
11. The farm Peover **772MS**
Registration Division **LS**, Limpopo Province

The diagram represents **2210.7775** hectares of land being a proclamation area for Happy Rest Nature Reserve affecting properties as listed in the schedule.

2020-01-29 09:00:00			
Mr. [REDACTED]		Mr. [REDACTED]	
[REDACTED]		[REDACTED]	
[REDACTED]		[REDACTED]	
[REDACTED]		[REDACTED]	
[REDACTED]		[REDACTED]	
[REDACTED]		[REDACTED]	
[REDACTED]		[REDACTED]	
[REDACTED]		[REDACTED]	
[REDACTED]		[REDACTED]	
[REDACTED]		[REDACTED]	
[REDACTED]		[REDACTED]	
[REDACTED]		[REDACTED]	
[REDACTED]		[REDACTED]	
[REDACTED]		[REDACTED]	
[REDACTED]		[REDACTED]	
[REDACTED]		[REDACTED]	
[REDACTED]		[REDACTED]	
[REDACTED]		[REDACTED]	
[REDACTED]		[REDACTED]	
[REDACTED]		[REDACTED]	
[REDACTED]		[REDACTED]	
[REDACTED]		[REDACTED]	
[REDACTED]		[REDACTED]	
[REDACTED]		[REDACTED]	
[REDACTED]		[REDACTED]	
[REDACTED]		[REDACTED]	
[REDACTED]		[REDACTED]	
[REDACTED]		[REDACTED]	
[REDACTED]		[REDACTED]	
[REDACTED]		[REDACTED]	
[REDACTED]		[REDACTED]	
[REDACTED]		[REDACTED]	
[REDACTED]		[REDACTED]	
[REDACTED]		[REDACTED]	
[REDACTED]		[REDACTED]	
[REDACTED]		[REDACTED]	
[REDACTED]		[REDACTED]	
[REDACTED]		[REDACTED]	
[REDACTED]		[REDACTED]	
[REDACTED]		[REDACTED]	
[REDACTED]		[REDACTED]	
[REDACTED]		[REDACTED]	
[REDACTED]		[REDACTED]	
[REDACTED]		[REDACTED]	
[REDACTED]		[REDACTED]	
[REDACTED]		[REDACTED]	
[REDACTED]		[REDACTED]	
[REDACTED]		[REDACTED]	
[REDACTED]		[REDACTED]	
[REDACTED]		[REDACTED]	
[REDACTED]		[REDACTED]	
[REDACTED]		[REDACTED]	
[REDACTED]		[REDACTED]	
[REDACTED]		[REDACTED]	
[REDACTED]		[REDACTED]	
[REDACTED]		[REDACTED]	
[REDACTED]		[REDACTED]	
[REDACTED]		[REDACTED]	
[REDACTED]		[REDACTED]	
[REDACTED]		[REDACTED]	
[REDACTED]		[REDACTED]	
[REDACTED]		[REDACTED]	
[REDACTED]		[REDACTED]	
[REDACTED]		[REDACTED]	
[REDACTED]		[REDACTED]	
[REDACTED]		[REDACTED]	
[REDACTED]		[REDACTED]	
[REDACTED]		[REDACTED]	
[REDACTED]		[REDACTED]	
[REDACTED]		[REDACTED]	
[REDACTED]		[REDACTED]	
[REDACTED]		[REDACTED]	
[REDACTED]		[REDACTED]	
[REDACTED]		[REDACTED]	
[REDACTED]		[REDACTED]	
[REDACTED]		[REDACTED]	
[REDACTED]		[REDACTED]	
[REDACTED]		[REDACTED]	
[REDACTED]		[REDACTED]	
[REDACTED]		[REDACTED]	
[REDACTED]		[REDACTED]	
[REDACTED]		[REDACTED]	
[REDACTED]		[REDACTED]	
[REDACTED]		[REDACTED]	
[REDACTED]		[REDACTED]	
[REDACTED]		[REDACTED]	
[REDACTED]		[REDACTED]	
[REDACTED]		[REDACTED]	
[REDACTED]		[REDACTED]	
[REDACTED]		[REDACTED]	
[REDACTED]		[REDACTED]	
[REDACTED]		[REDACTED]	
[REDACTED]		[REDACTED]	
[REDACTED]		[REDACTED]	
[REDACTED]		[REDACTED]	
[REDACTED]		[REDACTED]	
[REDACTED]		[REDACTED]	
[REDACTED]		[REDACTED]	
[REDACTED]		[REDACTED]	
[REDACTED]		[REDACTED]	
[REDACTED]		[REDACTED]	
[REDACTED]		[REDACTED]	
[REDACTED]		[REDACTED]	
[REDACTED]		[REDACTED]	
[REDACTED]		[REDACTED]	
[REDACTED]		[REDACTED]	
[REDACTED]		[REDACTED]	
[REDACTED]		[REDACTED]	
[REDACTED]		[REDACTED]	
[REDACTED]		[REDACTED]	
[REDACTED]		[REDACTED]	
[REDACTED]		[REDACTED]	
[REDACTED]		[REDACTED]	
[REDACTED]		[REDACTED]	
[REDACTED]		[REDACTED]	
[REDACTED]		[REDACTED]	
[REDACTED]		[REDACTED]	
[REDACTED]		[REDACTED]	
[REDACTED]		[REDACTED]	
[REDACTED]		[REDACTED]	
[REDACTED]		[REDACTED]	
[REDACTED]		[REDACTED]	
[REDACTED]		[REDACTED]	
[REDACTED]		[REDACTED]	
[REDACTED]		[REDACTED]	
[REDACTED]		[REDACTED]	
[REDACTED]		[REDACTED]	
[REDACTED]		[REDACTED]	
[REDACTED]		[REDACTED]	
[REDACTED]		[REDACTED]	
[REDACTED]		[REDACTED]	
[REDACTED]		[REDACTED]	
[REDACTED]		[REDACTED]	
[REDACTED]		[REDACTED]	
[REDACTED]		[REDACTED]	
[REDACTED]		[REDACTED]	
[REDACTED]		[REDACTED]	
[REDACTED]		[REDACTED]	
[REDACTED]		[REDACTED]	
[REDACTED]		[REDACTED]	
[REDACTED]		[REDACTED]	
[REDACTED]		[REDACTED]	
[REDACTED]		[REDACTED]	
[REDACTED]		[REDACTED]	
[REDACTED]		[REDACTED]	
[REDACTED]		[REDACTED]	
[REDACTED]		[REDACTED]	
[REDACTED]		[REDACTED]	
[REDACTED]		[REDACTED]	
[REDACTED]		[REDACTED]	
[REDACTED]		[REDACTED]	
[REDACTED]		[REDACTED]	
[REDACTED]		[REDACTED]	
[REDACTED]		[REDACTED]	
[REDACTED]		[REDACTED]	
[REDACTED]		[REDACTED]	
[REDACTED]		[REDACTED]	
[REDACTED]		[REDACTED]	
[REDACTED]		[REDACTED]	
[REDACTED]		[REDACTED]	
[REDACTED]		[REDACTED]	
[REDACTED]		[REDACTED]	
[REDACTED]		[REDACTED]	
[REDACTED]		[REDACTED]	
[REDACTED]		[REDACTED]	
[REDACTED]		[REDACTED]	
[REDACTED]		[REDACTED]	
[REDACTED]		[REDACTED]	
[REDACTED]		[REDACTED]	
[REDACTED]		[REDACTED]	
[REDACTED]		[REDACTED]	
[REDACTED]		[REDACTED]	
[REDACTED]		[REDACTED]	
[REDACTED]		[REDACTED]	
[REDACTED]		[REDACTED]	
[

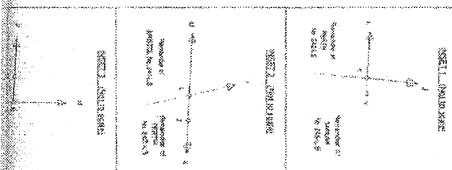
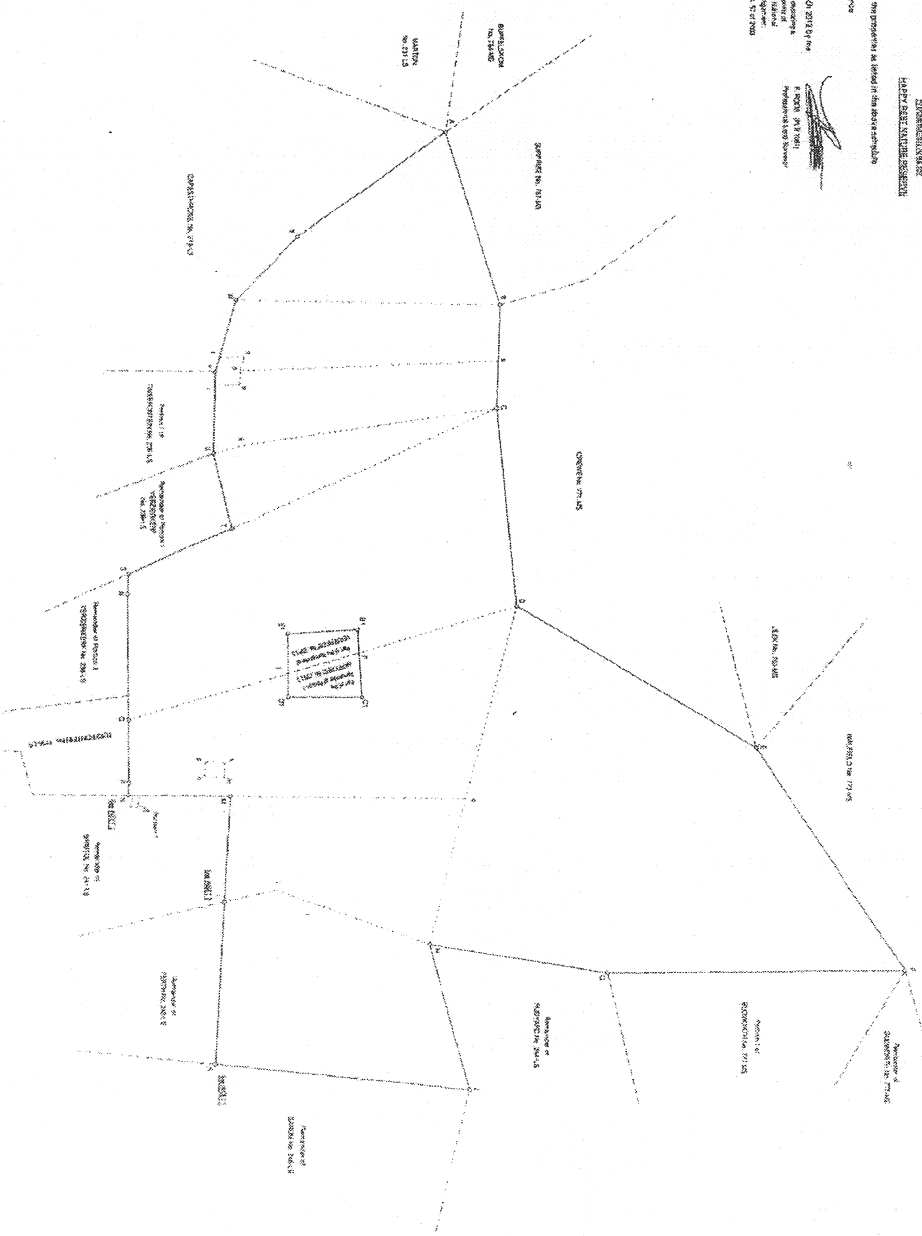

SCHEDULE 5(BOTHASVLEY NATURE RESERVE)

1. Remaining Extent of the farm **Bothasvley No. 19**

Registration Division **JR**, Limpopo Province

2. **Ownership:** Vested in the LIMPOPO PROVINCIAL GOVERNMENT, in terms of Section 239 of the Constitution of the Republic of South Africa, 1993 (Act 200 of 1993)
3. The diagram represents **1639.9753 hectares** of land being a proclamation area for **Bothasvley Nature Reserve**.

PROCLAMATION DIAGRAM

REGISTRATION COPY

Sheet 1 of 2 sheets

S.G. No.

97/2012

Approved

for
SURVEYOR-
GENERAL

2013-01-25

ACT 57 OF 2003
SECTION 23SCHEDULE OF AFFECTED PROPERTIES

1. The Figure A, B, C, D, E, F, J, h, g, f, e, d, x, b, a, M, N, k, S, A represents 1395,5610 hectares of land being the Remainder of the farm Bothasvley No. 19-JR Vide Diagram S.G. No. 10643/1894
2. The figure R, k, N, P, Q, R represents 51,3107 hectares of land being Portion 11 of farm Bothasvley No. 19-JR Vide Diagram S.G. No. A669/1988
3. The figure M, a, b, x, d, e, f, g, h, j, G, H, J, K, L, M represents 192,1036 hectares of land being a part of Portion 12 of the farm Bothasvley No. 19-JR (namely component 2) as depicted on Diagram S.G. No. A670/1988

The figure A B C D E F G H J K L M N P Q R S A

represents 1638,9753 hectares of land being

A Proclamation Area for BOTHASVLEY Nature Reserve affecting the properties as listed in the schedule

BOTHASVLEY No. 19-JR

LIMPOPO PROVINCE

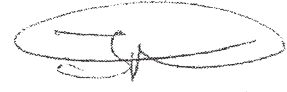
Compiled in January 2012 by me
FOR PROCLAMATION PURPOSES
H.T. NDHLOVU PLS1058
Professional Land Surveyor

This diagram is annexed to No. 110 of 2012 Registrar of Deeds PRETORIA	The original diagrams are as listed above Transfer Grant	File JR-19 S.P. G.P. Comp. JR - 15
--	--	------------------------------------

PROCLAMATION DIAGRAM

The figure A B C D E F G H J K L M N P Q R S T U V W X Y Z A1 B1 C1 D1 E1 F1 G1 H1 J1 K1
L1 M1 N1 P1 Q1 R1 S1 T1 U1 V1 W1 X1 Y1 Z1 A2 B2 A

represents 34 830,5814 hectares of land being
a Proclamation area for

WELGEVONDEN GAME RESERVE

and comprises the properties as listed in the schedule

Province of Limpopo

Framed for the purposes of declaring a Nature Reserve
in terms of Section 23(1) of the National Environmental
Management Protected Areas Act, 57 of 2003
in March 2013 by me

A.C. Calogero

A.C. CALOGERO (PLS 1039-D)
Professional Land Surveyor

Note:

All dimensions are approximate pending final survey

Servitude Notes:

For Servitude details, see S.G. Diagrams as
listed in the schedule

SH

SIDES
Metres

AB	3
BC	3
CD	1
DE	4
EF	4
FG	4
GH	2
HJ	
JK	4
KL	1
LM	2
MN	2
NP	2
PQ	5
QR	2
RS	2
ST	2
TU	
UV	2
WV	1
WX	
XY	
YZ	
ZA1	
A1B1	2
B1C1	2
C1D1	2
D1E1	
E1F1	2
F1G1	1
G1H1	1
H1J1	1
J1K1	
K1L1	2
L1M1	
M1N1	
N1P1	
P1Q1	
Q1R1	
R1S1	
S1T1	
T1U1	1
U1V1	3
V1W1	6
W1X1	4
X1Y1	4
Y1Z1	3
Z1A2	
A2B2	4
B2A	1

HE
ON
STE

SCHEDULE OF PROPERTIES AFFECTED

Description of Property	Area Hectares	Diagram
1 Welgevonden No. 470-KQ Portion 1	500,0021	A5268/1993
2 Welgevonden No. 470-KQ Portion 2	500,0035	A5269/1993
3 Welgevonden No. 470-KQ Portion 3	500,0000	A5270/1993
4 Welgevonden No. 470-KQ Portion 4	500,3693	A5271/1993
5 Welgevonden No. 470-KQ Portion 5	500,0000	A5272/1993
6 Welgevonden No. 470-KQ Portion 6	500,0003	A5273/1993
7 Welgevonden No. 470-KQ Portion 9	500,0017	A5276/1993
8 Welgevonden No. 470-KQ Portion 10	500,0004	A5277/1993
9 Welgevonden No. 470-KQ Portion 11	500,0001	A5278/1993
10 Welgevonden No. 470-KQ Portion 12	500,0002	A5279/1993
11 Welgevonden No. 470-KQ Portion 13	500,0001	A5280/1993
12 Welgevonden No. 470-KQ Portion 14	500,0003	A5281/1993
13 Welgevonden No. 470-KQ Portion 15	500,0013	A5282/1993
14 Welgevonden No. 470-KQ Portion 16	500,0000	A5283/1993
15 Welgevonden No. 470-KQ Portion 17	500,0008	A5284/1993
16 Welgevonden No. 470-KQ Portion 20	500,0002	A5287/1993
17 Welgevonden No. 470-KQ Portion 21	500,0002	A5288/1993
18 Welgevonden No. 470-KQ Portion 25	500,0002	A5292/1993
19 Welgevonden No. 470-KQ Portion 26	500,0778	A5293/1993
20 Welgevonden No. 470-KQ Portion 27	500,0003	A5294/1993
21 Welgevonden No. 470-KQ Portion 28	500,0002	A5295/1993
22 Welgevonden No. 470-KQ Portion 29	500,0001	A5296/1993
23 Welgevonden No. 470-KQ Portion 31	500,0069	A5298/1993
24 Welgevonden No. 470-KQ Portion 32	500,0005	A5299/1993
25 Welgevonden No. 470-KQ Portion 33	500,0004	A5300/1993
26 Welgevonden No. 470-KQ Portion 34	500,0002	A5301/1993
27 Welgevonden No. 470-KQ Portion 35	500,0000	A5302/1993
28 Welgevonden No. 470-KQ Portion 36	500,0136	A5303/1993

SCHEDULE OF PROPERTIES AFFECTED

Description of Property

49 Welgevonden No. 470-KQ Portion 63
50 Welgevonden No. 470-KQ Portion 64
51 Welgevonden No. 470-KQ Portion 70
52 Welgevonden No. 470-KQ Portion 71
53 Welgevonden No. 470-KQ Portion 79
54 Welgevonden No. 470-KQ Portion 80
55 Welgevonden No. 470-KQ Portion 82
56 Welgevonden No. 470-KQ Portion 83
57 Welgevonden No. 470-KQ Portion 87
58 Welgevonden No. 470-KQ Portion 91
59 Welgevonden No. 470-KQ Portion 92
60 Welgevonden No. 470-KQ Remainder