

Government Gazette

Staatskoerant

REPUBLIC OF SOUTH AFRICA
REPUBLIEK VAN SUID-AFRIKA

Vol. 544

Pretoria, 22 October 2010
Oktober

No. 33642

IMPORTANT NOTICE

The Government Printing Works will not be held responsible for faxed documents not received due to errors on the fax machine or faxes received which are unclear or incomplete. Please be advised that an "OK" slip, received from a fax machine, will not be accepted as proof that documents were received by the GPW for printing. If documents are faxed to the GPW it will be the sender's responsibility to phone and confirm that the documents were received in good order.

Furthermore the Government Printing Works will also not be held responsible for cancellations and amendments which have not been done on original documents received from clients.

CONTENTS**INHOUD**

| <i>No.</i> | <i>Page No.</i> | <i>Gazette No.</i> | <i>No.</i> | <i>Bladsy No.</i> | <i>Koerant No.</i> |
|--|---------------------|------------------------|--|-----------------------|------------------------|
| GOVERNMENT NOTICE | | | GOEWERMENTSKENNISGEWING | | |
| Transport, Department of | | | Vervoer, Departement van | | |
| <i>Government Notice</i> | | | <i>Goewermentskennisgewing</i> | | |
| 916 | | | 916 | | |
| South African National Roads Agency Limited and the National Roads Act (7/1998): The South African National Roads Agency Limited: Declaration amendment of National Road R33 Section 9: Amendment of Declaration No. 174 of 2007 | 3 | 33642 | Suid-Afrikaanse Nasionale Padagentskap Beperk en die Nasionale Paaie Wet (7/1998): Die Suid-Afrikaanse Nasionale Padagentskap Beperk: Verklaring wysiging van Nasionale Pad R33 Seksie 9: Wysiging van Verklaring No. 174 van 2007 | 4 | 33642 |

GOVERNMENT NOTICE

DEPARTMENT OF TRANSPORT

No. 916

22 October 2010

THE SOUTH AFRICAN NATIONAL ROADS AGENCY LIMITED

Registration No: 98/09584/06

DECLARATION AMENDMENT OF NATIONAL ROAD R33 SECTION 9

AMENDMENT OF DECLARATION No. 174 OF 2007

By virtue of section 40(1)(b) of the South African National Roads Agency Limited and the National Roads Act, 1998 (Act No. 7 of 1998), I hereby amend Declaration No. 174 of 2007, by substituting Annexure paragraphs (I), (II) and (III), with the subjoined sheets 1 to 12 of Plan No. P741/09.

(National Road R33 Section 9: Carolina – Belfast)



MINISTER OF TRANSPORT

GOEWERMENTSKENNISGEWING

DEPARTEMENT VAN VERVOER

No. 916

22 Oktober 2010

DIE SUID-AFRIKAANSE NASIONALE PADAGENTSKAP BEPERK

Registrasie No: 98/09584/06

VERKLARING WYSIGING VAN NASIONALE PAD R33 SEKSIE 9.

WYSIGING VAN VERKLARING NO. 174 VAN 2007

Kragtens Artikel 40(1)(b) van die Suid-Afrikaanse Nasionale Padagentskap Beperk en die Nasionale Paaie Wet, 1998 (Wet no.7 van 1998), wysig ek hiermee Verklaring no.174 van 2007, deur Bylae paragrawe (I), (II) en (III), te vervang met meegaande velle 1 tot 12 van Plan no. P741/09.

(Nasionale Pad R33 Seksie 9: Carolina – Belfast)

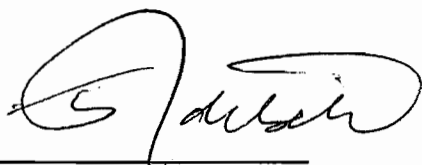

MINISTER VAN VERVOER

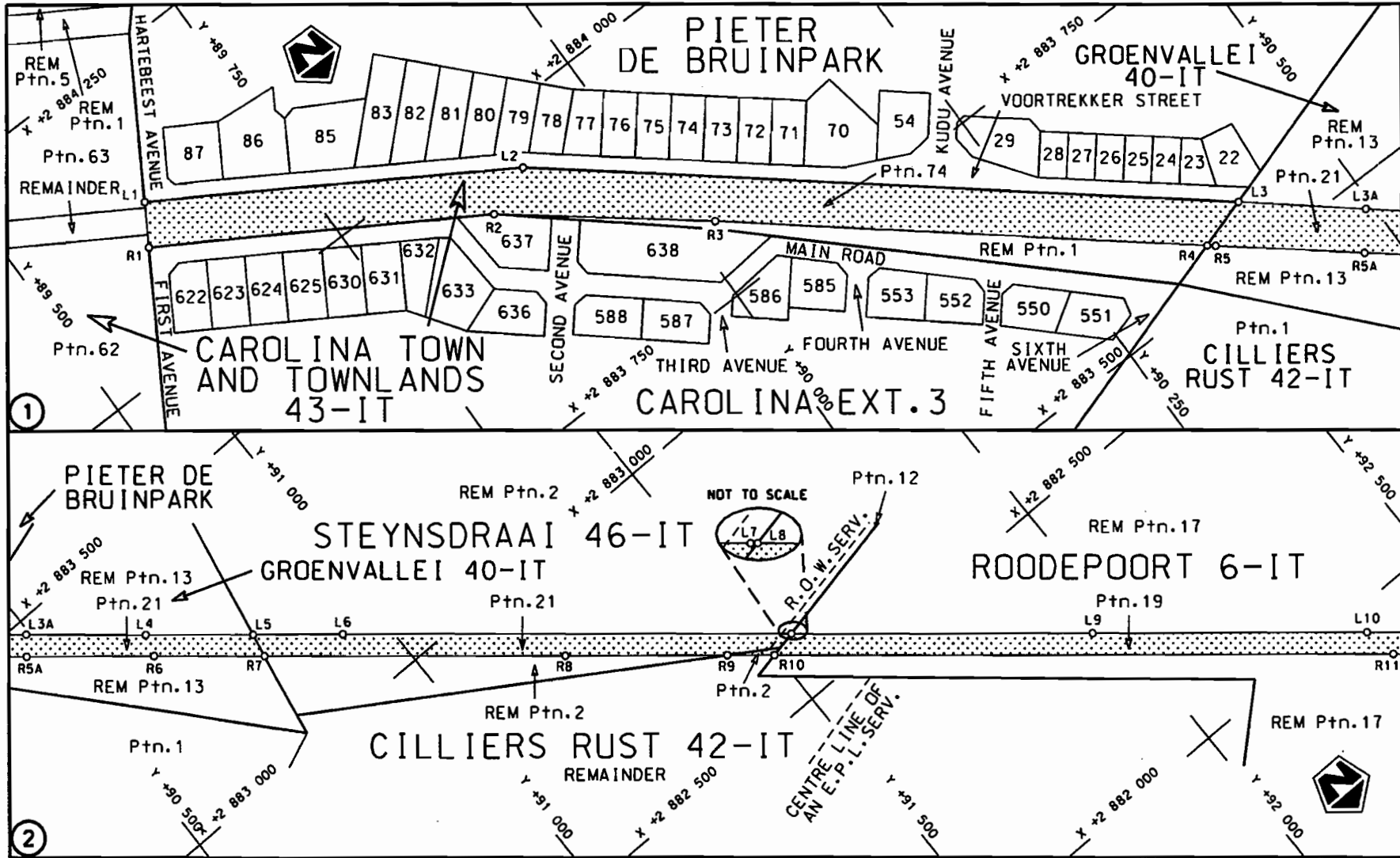

| | | | | |
|--|---------------------------------------|---|--|---------------------------------------|
| Die Suid Afrikaanse Nasionale Padogentskap Beprek The South African National Roads Agency Limited | Die figuur getoon The figure shown |  | steldie padreserwe voor van 'n gedeelte represents the road reserve of a portion van Nasionale Roete R33 Seksie Section of National Route 9 | Vel Sheet 1 van of 12 Plan P741/09 |
|--|---------------------------------------|---|--|---------------------------------------|

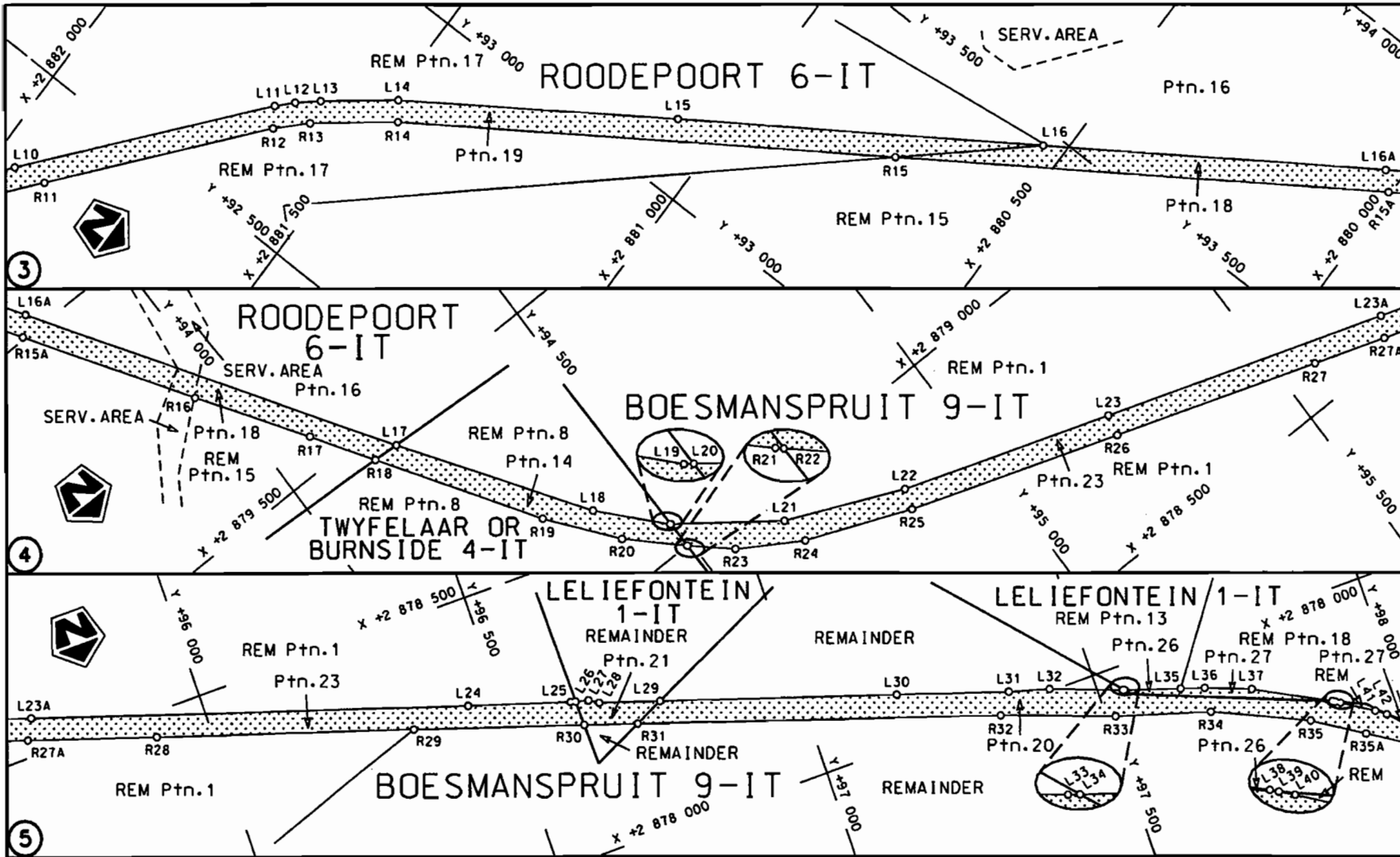

| | | | |
|--|---|---|------------------------------|
| <p>Die Suid Afrikaanse Nasionale Padagentskap Beperk The South African National Roads Agency Limited</p> | <p>Die figuur getoon The figure shown</p> | <p>steldie padreserwe voor van 'n gedeelte represents the road reserve of a portion van Nasionale Roete R33 of National Route R33</p> | <p>Vel Sheet 2 van of 12</p> |
| <p>Seksie Section 9</p> | | | <p>Plan P741/09</p> |

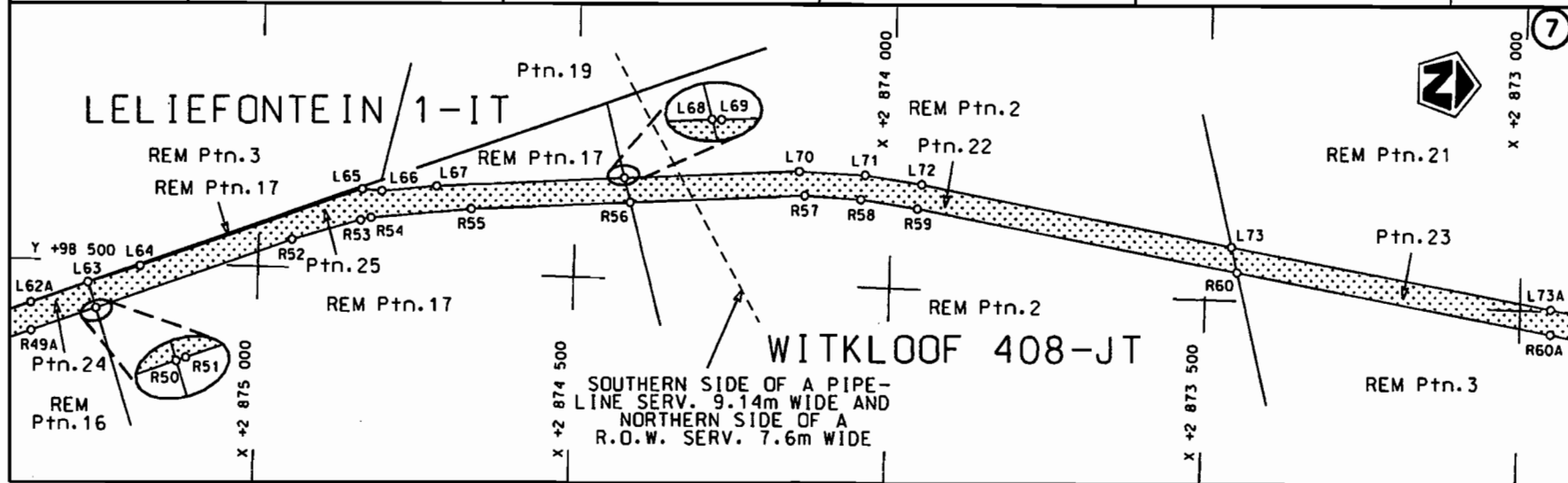
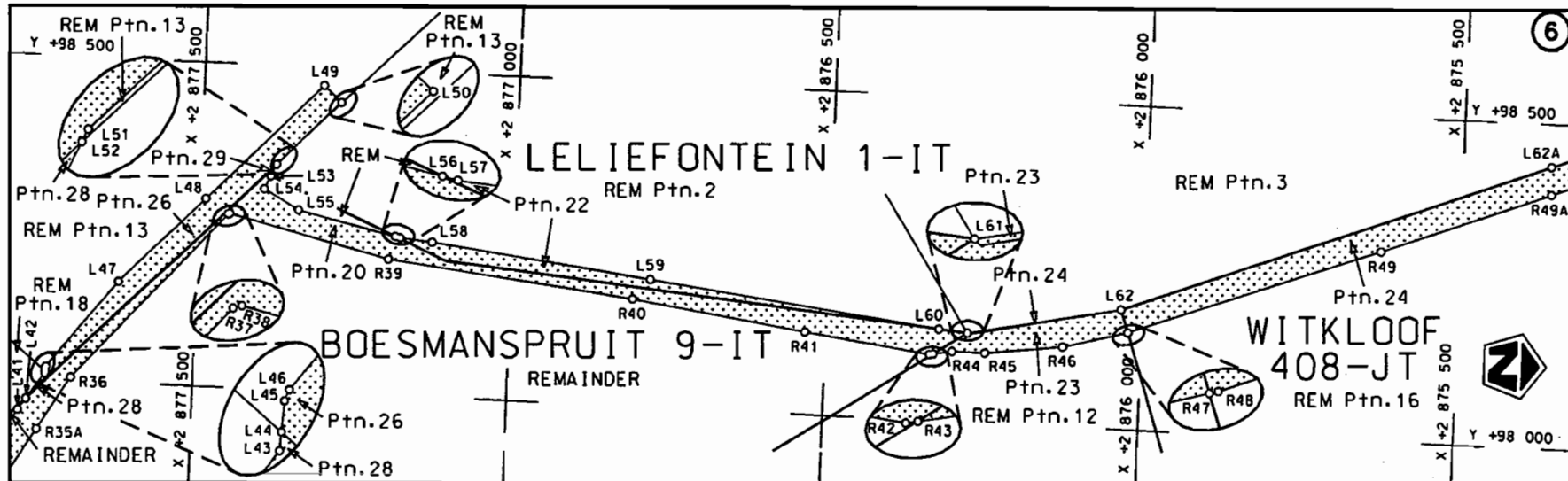

| | | | | |
|---|-------------------|--|---|-----------------------|
| Die Suid Afrikaanse Nasionale Padagentskap Beperk | Die figuur getoon |  | steldie padreserwe voor van 'n gedeelte represents the road reserve of a portion van Nasionale Roete R33 Seksie Section of National Route R33 Sektie Section | Vel Sheet 3 van of 12 |
| The South African National Roads Agency Limited | The figure shown | | Plan P741/09 | |

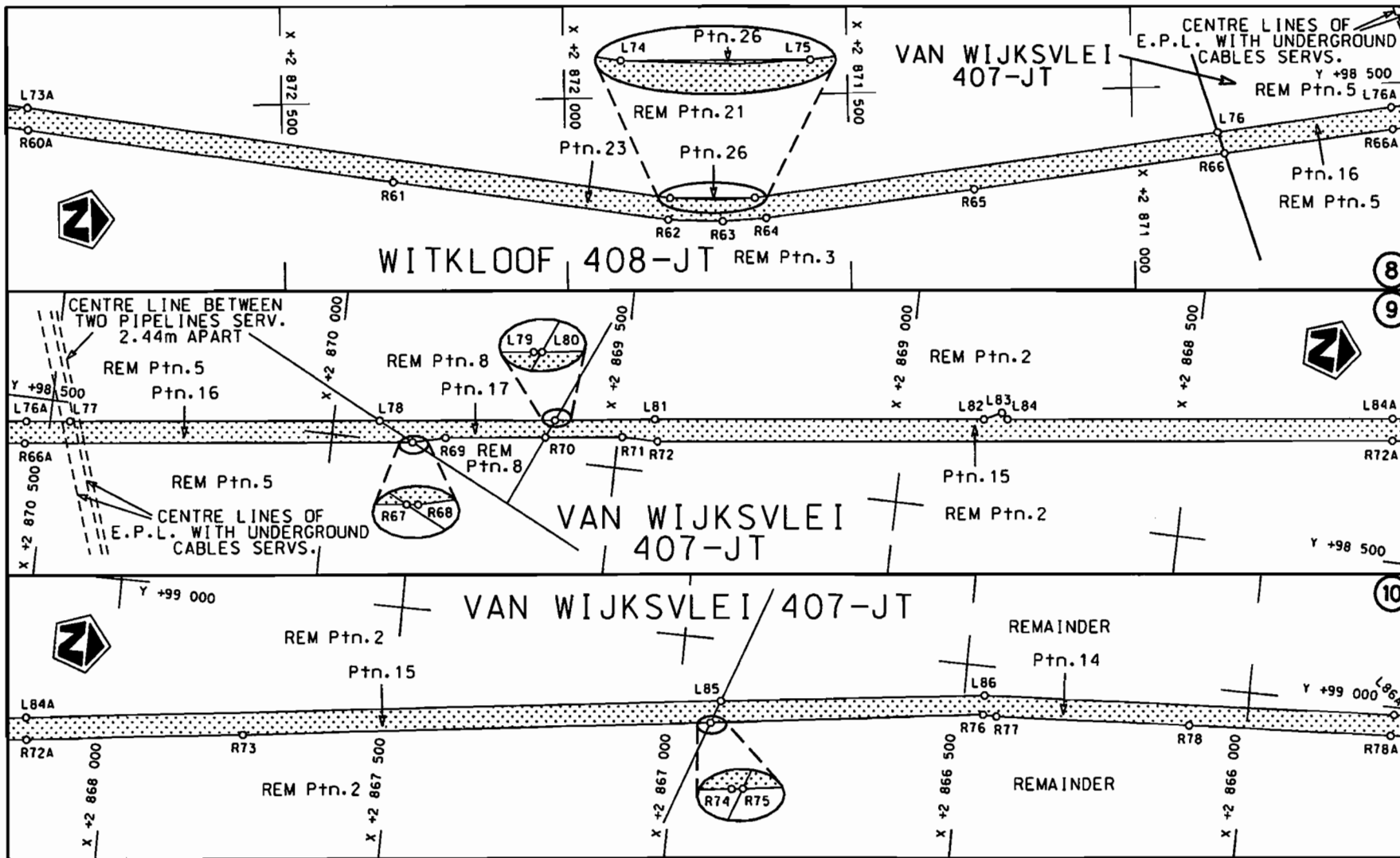

| | | | |
|--|---|--|---|
| <p>Die Suid Afrikaanse Nasionale Padagentskap Beperk The South African National Roads Agency Limited</p> | <p>Die figuur getoon The figure shown</p>  | <p>stel die padreserwe voor van 'n gedeelte represents the road reserve of a portion van Nasionale Roete R33 of National Route R33</p> <p>Seksie 9 Section 9</p> | <p>Vel 4 van 12 Sheet 4 of 12</p> <p>Plan P741/09</p> |
|--|---|--|---|

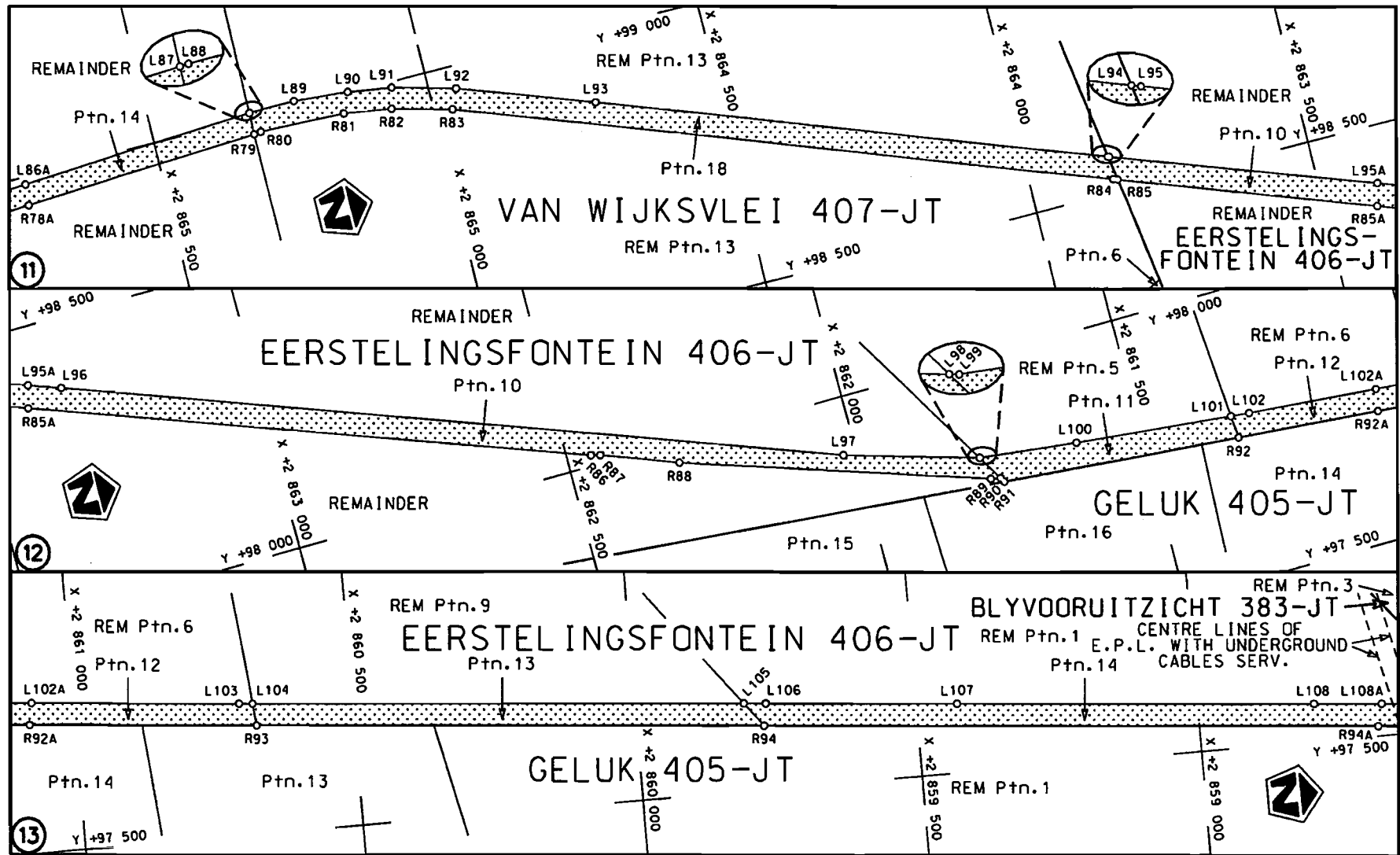

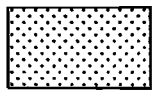
| | | | | |
|--|---|--|--|--|
| <p>Die Suid Afrikaanse Nasionale Padogentskap Beperk The South African National Roads Agency Limited</p> | <p>Die figuur getoon The figure shown</p> |  | <p>steldie padreserwe voor van 'n gedeelte represents the road reserve of a portion van Nasionale Roete R33 Seksie of National Route Section</p> | <p>Vel Sheet 5 von 12 Plan P741/09</p> |
|--|---|--|--|--|

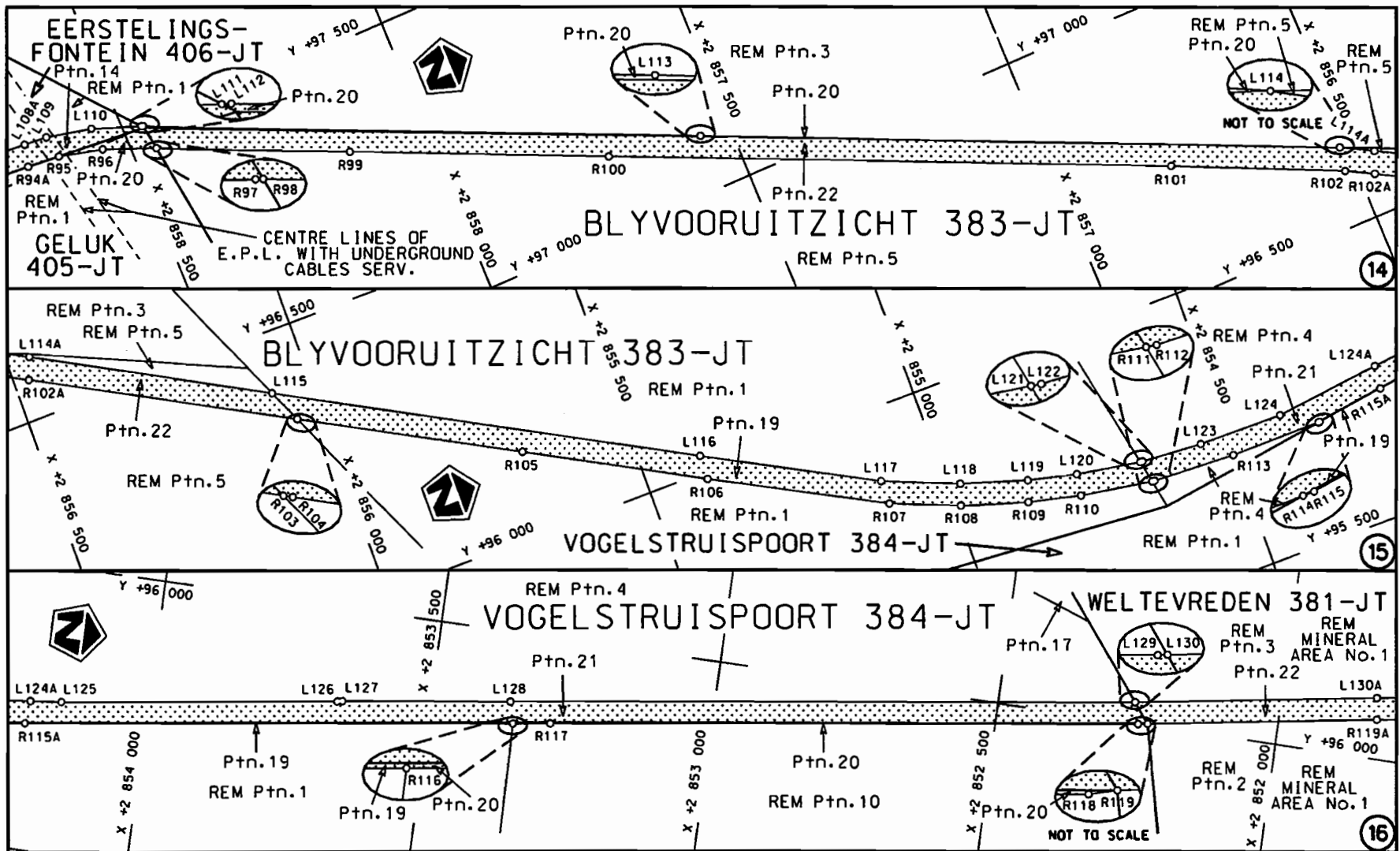

| | | | | |
|--|---|--|--|--|
| <p>Die Suid Afrikaanse Nasionale Podagentskap Beperk The South African National Roads Agency Limited</p> | <p>Die figuur getoon The figure shown</p> |  | <p>steldie padreserwe voor van 'n gedeelte represents the road reserve of a portion van Nasionale Roete of National Route R33 Seksie Section 9</p> | <p>Vel Sheet 6 van 12 Plan P741/09</p> |
|--|---|--|--|--|

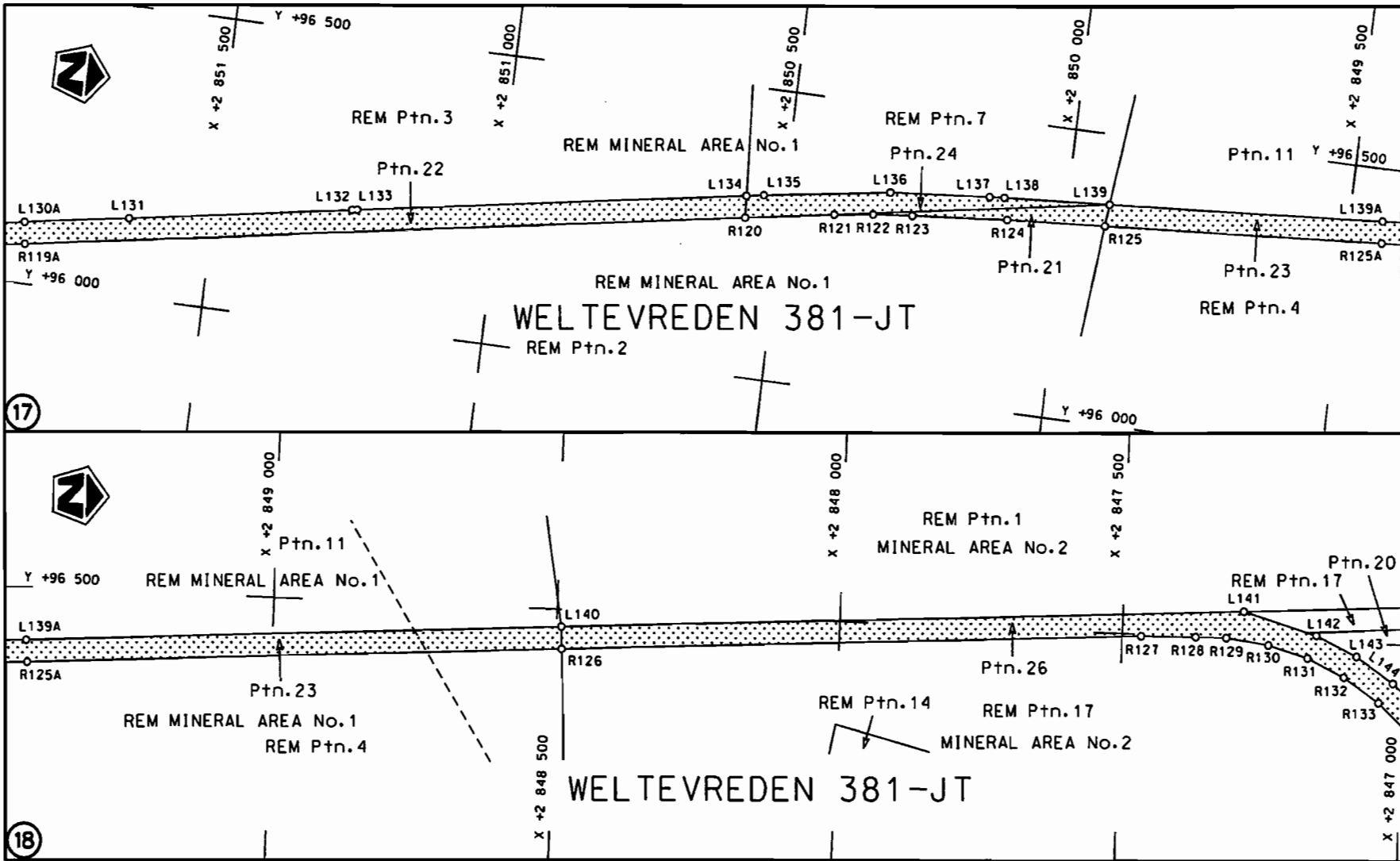

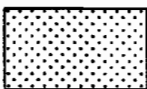
| | | | |
|--|---------------------------------------|--|---------------------------------------|
| Die Suid Afrikaanse Nasionale Padagentskap Beperk The South African National Roads Agency Limited | Die figuur getoon The figure shown |  steldie podreserwe voor van 'n gedeelte represents the road reserve of a portion van Nasionale Roete R33 Sektie of National Route R33 Section | Vel Sheet 7 van of 12 Plon P741/09 |
|--|---------------------------------------|--|---------------------------------------|

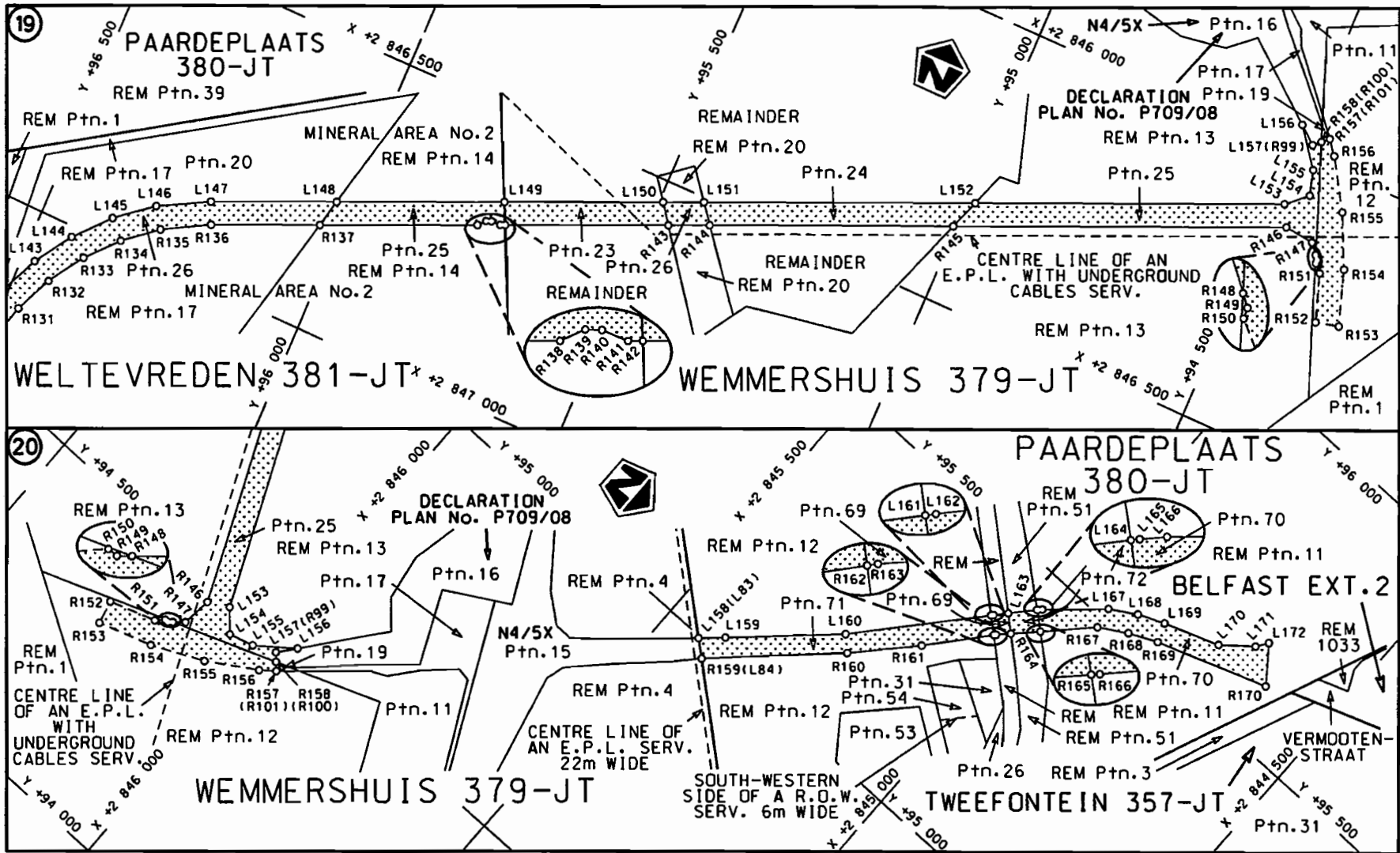

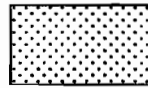
| | | | |
|--|--|---|--|
| <p>Die Suid Afrikaanse Nasionale Padogentskap Beperk The South African National Roads Agency Limited</p> | <p>Die figuur getoon The figure shown</p>  | <p>steldie podreserwe voor van 'n gedeelte represents the road reserve of a portion van Nasionale Roete of National Route</p> <p>R33 Seksie Section</p> <p>9</p> | <p>Vel Sheet 8 van of 12</p> <p>Plan P741/09</p> |
|--|--|---|--|

| PADRESERWE KOÖRDINATE | | | | / | ROAD RESERVE CO-ORDINATES | | | |
|---------------------------|------------|---------------|----|-----|----------------------------|---------------|--|--|
| LINKERKANT/LEFT HAND SIDE | | | | | REGTERKANT/RIGHT HAND SIDE | | | |
| | Y | X | WG | 31° | Y | X | | |
| L1 | 89 626.670 | 2 884 129.530 | | R1 | 89 605.990 | 2 884 095.830 | | |
| L2 | 89 913.910 | 2 883 951.850 | | R2 | 89 869.270 | 2 883 934.880 | | |
| L3 | 90 406.070 | 2 883 548.920 | | R3 | 90 022.580 | 2 883 813.260 | | |
| L4 | 90 657.090 | 2 883 339.660 | | R4 | 90 361.280 | 2 883 535.440 | | |
| L5 | 90 806.870 | 2 883 216.770 | | R5 | 90 366.940 | 2 883 530.800 | | |
| L6 | 90 930.180 | 2 883 115.600 | | R6 | 90 645.210 | 2 883 302.400 | | |
| L7 | 91 543.080 | 2 882 609.850 | | R7 | 90 799.530 | 2 883 175.040 | | |
| L8 | 91 543.190 | 2 882 609.760 | | R8 | 91 210.500 | 2 882 835.850 | | |
| L9 | 91 957.420 | 2 882 269.700 | | R9 | 91 431.280 | 2 882 654.160 | | |
| L10 | 92 333.830 | 2 881 960.140 | | R10 | 91 496.540 | 2 882 600.450 | | |
| L11 | 92 699.500 | 2 881 657.400 | | R11 | 92 345.560 | 2 881 901.750 | | |
| L12 | 92 726.830 | 2 881 631.810 | | R12 | 92 666.920 | 2 881 636.320 | | |
| L13 | 92 756.840 | 2 881 597.110 | | R13 | 92 714.800 | 2 881 589.170 | | |
| L14 | 92 842.070 | 2 881 488.680 | | R14 | 92 811.550 | 2 881 466.200 | | |
| L15 | 93 115.590 | 2 881 077.400 | | R15 | 93 297.970 | 2 880 732.570 | | |
| L16 | 93 472.730 | 2 880 537.690 | | R16 | 93 959.260 | 2 879 735.180 | | |
| L17 | 94 193.130 | 2 879 451.090 | | R17 | 94 080.840 | 2 879 556.920 | | |
| L18 | 94 397.830 | 2 879 149.780 | | R18 | 94 148.720 | 2 879 453.380 | | |
| L19 | 94 490.980 | 2 879 048.140 | | R19 | 94 319.470 | 2 879 192.910 | | |
| L20 | 94 492.160 | 2 879 047.280 | | R20 | 94 408.450 | 2 879 079.950 | | |
| L21 | 94 653.740 | 2 878 929.860 | | R21 | 94 491.880 | 2 879 000.400 | | |
| L22 | 94 856.980 | 2 878 842.120 | | R22 | 94 492.350 | 2 878 999.990 | | |
| L23 | 95 219.920 | 2 878 722.510 | | R23 | 94 555.320 | 2 878 944.500 | | |
| L24 | 96 443.440 | 2 878 321.780 | | R24 | 94 661.850 | 2 878 880.580 | | |
| L25 | 96 616.360 | 2 878 266.870 | | R25 | 94 845.730 | 2 878 807.060 | | |
| L26 | 96 625.110 | 2 878 264.570 | | R26 | 95 211.300 | 2 878 686.170 | | |
| L27 | 96 646.690 | 2 878 258.900 | | R27 | 95 563.430 | 2 878 570.350 | | |
| L28 | 96 663.270 | 2 878 248.760 | | R28 | 95 905.000 | 2 878 458.150 | | |
| L29 | 96 765.120 | 2 878 215.470 | | R29 | 96 340.090 | 2 878 315.580 | | |
| L30 | 97 162.860 | 2 878 085.440 | | R30 | 96 625.660 | 2 878 221.500 | | |
| L31 | 97 350.870 | 2 878 023.900 | | R31 | 96 714.950 | 2 878 191.950 | | |
| L32 | 97 420.890 | 2 878 003.770 | | R32 | 97 323.530 | 2 877 990.510 | | |
| L33 | 97 542.020 | 2 877 958.580 | | R33 | 97 515.400 | 2 877 920.490 | | |
| L34 | 97 545.390 | 2 877 957.490 | | R34 | 97 676.600 | 2 877 871.260 | | |
| L35 | 97 640.290 | 2 877 926.560 | | R35 | 97 837.410 | 2 877 797.550 | | |
| L36 | 97 680.530 | 2 877 913.440 | | R36 | 98 004.960 | 2 877 691.830 | | |
| L37 | 97 757.390 | 2 877 883.580 | | R37 | 98 267.540 | 2 877 453.600 | | |
| L38 | 97 885.150 | 2 877 816.290 | | R38 | 98 268.230 | 2 877 451.220 | | |
| L39 | 97 889.860 | 2 877 813.550 | | R39 | 98 208.550 | 2 877 194.120 | | |
| L40 | 97 898.300 | 2 877 808.640 | | R40 | 98 164.780 | 2 876 806.590 | | |
| L41 | 97 951.730 | 2 877 775.040 | | R41 | 98 126.990 | 2 876 532.500 | | |
| L42 | 97 969.100 | 2 877 762.490 | | R42 | 98 101.370 | 2 876 334.150 | | |
| L43 | 98 009.340 | 2 877 733.410 | | R43 | 98 102.550 | 2 876 327.640 | | |
| L44 | 98 012.580 | 2 877 733.200 | | R44 | 98 107.890 | 2 876 298.060 | | |
| L45 | 98 017.910 | 2 877 732.860 | | R45 | 98 107.830 | 2 876 245.620 | | |
| L46 | 98 019.840 | 2 877 732.040 | | R46 | 98 122.860 | 2 876 123.650 | | |
| L47 | 98 155.080 | 2 877 622.590 | | R47 | 98 149.680 | 2 876 021.670 | | |
| L48 | 98 289.670 | 2 877 490.410 | | R48 | 98 149.740 | 2 876 021.440 | | |
| L49 | 98 472.420 | 2 877 306.590 | | R49 | 98 292.300 | 2 875 625.750 | | |
| L50 | 98 447.390 | 2 877 278.320 | | R50 | 98 428.550 | 2 875 255.550 | | |
| L51 | 98 347.400 | 2 877 378.920 | | R51 | 98 428.600 | 2 875 255.420 | | |

| | | | | |
|-------|---|-----|----|---------|
| Vel | 9 | Van | 12 | P741/09 |
| Sheet | | of | | |

| PADRESERWE KOÖRDINATE | | | | / | ROAD RESERVE CO-ORDINATES | | | |
|---------------------------|------------|---------------|----|------|----------------------------|---------------|--|--|
| LINKERKANT/LEFT HAND SIDE | | | | | REGTERKANT/RIGHT HAND SIDE | | | |
| | Y | X | WG | 31° | Y | X | | |
| L52 | 98 347.180 | 2 877 379.020 | | R52 | 98 543.230 | 2 874 945.440 | | |
| L53 | 98 328.910 | 2 877 387.670 | | R53 | 98 576.760 | 2 874 836.840 | | |
| L54 | 98 308.540 | 2 877 397.310 | | R54 | 98 580.940 | 2 874 820.640 | | |
| L55 | 98 278.020 | 2 877 340.200 | | R55 | 98 599.450 | 2 874 663.760 | | |
| L56 | 98 243.990 | 2 877 185.050 | | R56 | 98 617.570 | 2 874 412.320 | | |
| L57 | 98 242.200 | 2 877 176.880 | | R57 | 98 637.370 | 2 874 137.600 | | |
| L58 | 98 237.650 | 2 877 126.570 | | R58 | 98 634.430 | 2 874 048.850 | | |
| L59 | 98 195.960 | 2 876 779.590 | | R59 | 98 623.370 | 2 873 958.680 | | |
| L60 | 98 141.100 | 2 876 320.160 | | R60 | 98 543.060 | 2 873 449.600 | | |
| L61 | 98 137.090 | 2 876 274.510 | | R61 | 98 362.150 | 2 872 302.730 | | |
| L62 | 98 184.510 | 2 876 033.530 | | R62 | 98 287.820 | 2 871 819.720 | | |
| L63 | 98 467.510 | 2 875 268.790 | | R63 | 98 283.120 | 2 871 724.170 | | |
| L64 | 98 495.040 | 2 875 187.150 | | R64 | 98 287.310 | 2 871 648.080 | | |
| L65 | 98 624.350 | 2 874 835.540 | | R65 | 98 330.460 | 2 871 279.770 | | |
| L66 | 98 622.400 | 2 874 804.610 | | R66 | 98 384.020 | 2 870 837.220 | | |
| L67 | 98 632.660 | 2 874 718.930 | | R67 | 98 502.660 | 2 869 857.010 | | |
| L68 | 98 654.980 | 2 874 422.970 | | R68 | 98 502.710 | 2 869 856.530 | | |
| L69 | 98 654.980 | 2 874 422.920 | | R69 | 98 516.790 | 2 869 800.240 | | |
| L70 | 98 674.260 | 2 874 147.030 | | R70 | 98 537.840 | 2 869 627.000 | | |
| L71 | 98 672.100 | 2 874 042.870 | | R71 | 98 554.210 | 2 869 492.270 | | |
| L72 | 98 660.620 | 2 873 952.790 | | R72 | 98 554.110 | 2 869 428.940 | | |
| L73 | 98 582.050 | 2 873 459.580 | | R73 | 98 754.230 | 2 867 761.670 | | |
| L74 | 98 325.080 | 2 871 815.560 | | R74 | 98 854.330 | 2 866 941.370 | | |
| L75 | 98 322.850 | 2 871 667.160 | | R75 | 98 854.410 | 2 866 940.720 | | |
| L76 | 98 420.560 | 2 870 848.880 | | R76 | 98 916.020 | 2 866 464.270 | | |
| L77 | 98 467.470 | 2 870 464.810 | | R77 | 98 915.140 | 2 866 440.510 | | |
| L78 | 98 532.730 | 2 869 918.700 | | R78 | 98 933.610 | 2 866 100.080 | | |
| L79 | 98 569.200 | 2 869 613.520 | | R79 | 98 971.070 | 2 865 322.030 | | |
| L80 | 98 569.250 | 2 869 613.120 | | R80 | 98 972.330 | 2 865 309.240 | | |
| L81 | 98 591.670 | 2 869 438.200 | | R81 | 98 967.350 | 2 865 157.460 | | |
| L82 | 98 660.380 | 2 868 862.050 | | R82 | 98 954.480 | 2 865 072.420 | | |
| L83 | 98 675.320 | 2 868 831.940 | | R83 | 98 926.810 | 2 864 967.060 | | |
| L84 | 98 665.230 | 2 868 821.070 | | R84 | 98 523.150 | 2 863 854.140 | | |
| L85 | 98 893.550 | 2 866 926.390 | | R85 | 98 520.480 | 2 863 846.760 | | |
| L86 | 98 949.210 | 2 866 464.560 | | R86 | 98 018.630 | 2 862 457.830 | | |
| L87 | 99 009.260 | 2 865 321.830 | | R87 | 98 014.580 | 2 862 441.780 | | |
| L88 | 99 009.290 | 2 865 321.320 | | R88 | 97 964.820 | 2 862 308.280 | | |
| L89 | 99 009.670 | 2 865 237.910 | | R89 | 97 792.960 | 2 861 779.240 | | |
| L90 | 99 002.110 | 2 865 141.710 | | R90 | 97 789.690 | 2 861 762.090 | | |
| L91 | 98 990.290 | 2 865 063.440 | | R91 | 97 781.530 | 2 861 757.000 | | |
| L92 | 98 960.500 | 2 864 952.260 | | R92 | 97 745.110 | 2 861 333.580 | | |
| L93 | 98 876.820 | 2 864 718.490 | | R93 | 97 688.440 | 2 860 674.920 | | |
| L94 | 98 563.440 | 2 863 853.610 | | R94 | 97 610.830 | 2 859 772.710 | | |
| L95 | 98 562.650 | 2 863 851.440 | | R95 | 97 512.030 | 2 858 624.260 | | |
| L96 | 98 380.040 | 2 863 340.890 | | R96 | 97 492.600 | 2 858 546.710 | | |
| L97 | 97 901.210 | 2 862 023.300 | | R97 | 97 457.180 | 2 858 457.730 | | |
| L98 | 97 832.990 | 2 861 789.110 | | R98 | 97 457.110 | 2 858 457.550 | | |
| L99 | 97 832.810 | 2 861 788.480 | | R99 | 97 316.020 | 2 858 139.010 | | |
| L100 | 97 813.040 | 2 861 615.540 | | R100 | 97 128.020 | 2 857 718.270 | | |
| L101 | 97 784.350 | 2 861 336.940 | | R101 | 96 723.000 | 2 856 803.220 | | |
| L102 | 97 780.980 | 2 861 304.240 | | R102 | 96 594.460 | 2 856 519.720 | | |

| | | | | |
|-------|----|-----|----|---------|
| Vel | 10 | Van | 12 | P741/09 |
| Sheet | | of | | |

| PADRESERWE KOÖRDINATE | | | | / | ROAD RESERVE CO-ORDINATES | | | | |
|---------------------------|------------|---------------|----|------|----------------------------|---------------|-----|----|---------|
| LINKERKANT/LEFT HAND SIDE | | | | | REGTERKANT/RIGHT HAND SIDE | | | | |
| | Y | X | WG | 31° | Y | X | | | |
| L103 | 97 728.750 | 2 860 703.290 | | R103 | 96 339.130 | 2 856 045.050 | | | |
| L104 | 97 726.690 | 2 860 679.070 | | R104 | 96 338.910 | 2 856 044.640 | | | |
| L105 | 97 652.240 | 2 859 805.690 | | R105 | 96 145.330 | 2 855 687.360 | | | |
| L106 | 97 648.900 | 2 859 766.470 | | R106 | 95 986.900 | 2 855 395.830 | | | |
| L107 | 97 620.180 | 2 859 426.840 | | R107 | 95 834.540 | 2 855 106.550 | | | |
| L108 | 97 564.910 | 2 858 792.330 | | R108 | 95 787.340 | 2 854 989.040 | | | |
| L109 | 97 551.570 | 2 858 631.920 | | R109 | 95 751.120 | 2 854 872.730 | | | |
| L110 | 97 533.560 | 2 858 551.090 | | R110 | 95 729.160 | 2 854 780.650 | | | |
| L111 | 97 502.660 | 2 858 467.520 | | R111 | 95 708.970 | 2 854 654.050 | | | |
| L112 | 97 501.490 | 2 858 464.350 | | R112 | 95 708.290 | 2 854 649.820 | | | |
| L113 | 97 096.890 | 2 857 554.150 | | R113 | 95 701.820 | 2 854 502.200 | | | |
| L114 | 96 635.980 | 2 856 512.470 | | R114 | 95 702.550 | 2 854 339.000 | | | |
| L115 | 96 396.550 | 2 856 071.320 | | R115 | 95 702.560 | 2 854 336.650 | | | |
| L116 | 96 029.000 | 2 855 394.150 | | R116 | 95 841.830 | 2 853 349.850 | | | |
| L117 | 95 876.120 | 2 855 106.680 | | R117 | 95 851.160 | 2 853 283.750 | | | |
| L118 | 95 823.440 | 2 854 976.640 | | R118 | 95 999.610 | 2 852 247.910 | | | |
| L119 | 95 787.050 | 2 854 860.540 | | R119 | 96 002.520 | 2 852 231.150 | | | |
| L120 | 95 766.460 | 2 854 774.410 | | R120 | 96 274.380 | 2 850 564.490 | | | |
| L121 | 95 747.880 | 2 854 662.230 | | R121 | 96 299.900 | 2 850 407.990 | | | |
| L122 | 95 747.190 | 2 854 658.090 | | R122 | 96 308.860 | 2 850 339.560 | | | |
| L123 | 95 739.870 | 2 854 549.850 | | R123 | 96 314.980 | 2 850 270.740 | | | |
| L124 | 95 737.740 | 2 854 399.380 | | R124 | 96 329.560 | 2 850 103.300 | | | |
| L125 | 95 765.730 | 2 854 155.690 | | R125 | 96 340.610 | 2 849 929.350 | | | |
| L126 | 95 835.790 | 2 853 664.960 | | R126 | 96 432.090 | 2 848 489.480 | | | |
| L127 | 95 837.940 | 2 853 655.570 | | R127 | 96 497.060 | 2 847 466.860 | | | |
| L128 | 95 879.130 | 2 853 359.340 | | R128 | 96 499.450 | 2 847 370.430 | | | |
| L129 | 96 036.520 | 2 852 258.440 | | R129 | 96 500.010 | 2 847 316.480 | | | |
| L130 | 96 036.590 | 2 852 258.060 | | R130 | 96 490.520 | 2 847 241.970 | | | |
| L131 | 96 136.060 | 2 851 647.010 | | R131 | 96 470.840 | 2 847 171.160 | | | |
| L132 | 96 200.080 | 2 851 254.750 | | R132 | 96 440.190 | 2 847 104.950 | | | |
| L133 | 96 201.610 | 2 851 245.520 | | R133 | 96 398.910 | 2 847 042.120 | | | |
| L134 | 96 312.020 | 2 850 566.910 | | R134 | 96 350.080 | 2 846 988.330 | | | |
| L135 | 96 317.040 | 2 850 536.080 | | R135 | 96 293.190 | 2 846 942.180 | | | |
| L136 | 96 350.010 | 2 850 314.150 | | R136 | 96 213.950 | 2 846 898.300 | | | |
| L137 | 96 364.800 | 2 850 139.490 | | R137 | 96 034.920 | 2 846 819.270 | | | |
| L138 | 96 366.720 | 2 850 112.930 | | R138 | 95 779.130 | 2 846 706.340 | | | |
| L139 | 96 378.580 | 2 849 925.640 | | R139 | 95 768.130 | 2 846 694.240 | | | |
| L140 | 96 470.340 | 2 848 491.530 | | R140 | 95 758.860 | 2 846 690.520 | | | |
| L141 | 96 546.530 | 2 847 287.020 | | R141 | 95 742.450 | 2 846 690.150 | | | |
| L142 | 96 510.260 | 2 847 156.790 | | R142 | 95 734.390 | 2 846 686.600 | | | |
| L143 | 96 476.900 | 2 847 083.730 | | R143 | 95 468.580 | 2 846 569.590 | | | |
| L144 | 96 433.010 | 2 847 017.760 | | R144 | 95 401.740 | 2 846 540.160 | | | |
| L145 | 96 379.140 | 2 846 958.120 | | R145 | 95 005.500 | 2 846 365.740 | | | |
| L146 | 96 316.620 | 2 846 907.950 | | R146 | 94 464.640 | 2 846 127.640 | | | |
| L147 | 96 230.200 | 2 846 861.470 | | R147 | 94 412.480 | 2 846 133.440 | | | |
| L148 | 96 022.950 | 2 846 770.170 | | R148 | 94 397.550 | 2 846 150.600 | | | |
| L149 | 95 751.630 | 2 846 650.640 | | R149 | 94 391.670 | 2 846 157.350 | | | |
| L150 | 95 493.180 | 2 846 536.780 | | R150 | 94 391.260 | 2 846 163.830 | | | |
| L151 | 95 427.410 | 2 846 507.800 | | R151 | 94 378.180 | 2 846 176.740 | | | |
| L152 | 94 986.440 | 2 846 313.530 | | R152 | 94 350.370 | 2 846 257.550 | | | |
| L153 | 94 484.010 | 2 846 092.180 | | R153 | 94 309.680 | 2 846 247.360 | | | |
| | | | | | Vel | 11 | Van | 12 | P741/09 |
| | | | | | Sheet | | of | | |

| PADRESERWE KOÖRDINATE | | | | / | ROAD RESERVE CO-ORDINATES | | | |
|---------------------------|------------|-------|---------|------|----------------------------|-------|---------|--|
| LINKERKANT/LEFT HAND SIDE | | | | | REGTERKANT/RIGHT HAND SIDE | | | |
| | Y | X | WG | 31° | Y | X | | |
| L154 | 94 448.870 | 2 846 | 060.580 | R154 | 94 341.230 | 2 846 | 153.360 | |
| L155 | 94 461.610 | 2 846 | 017.360 | R155 | 94 384.120 | 2 846 | 063.590 | |
| L156 | 94 510.970 | 2 845 | 953.470 | R156 | 94 436.770 | 2 845 | 980.290 | |
| L157 | 94 479.820 | 2 845 | 978.430 | R157 | 94 455.990 | 2 845 | 956.000 | |
| L158 | 94 996.780 | 2 845 | 431.480 | R158 | 94 467.710 | 2 845 | 967.040 | |
| L159 | 95 029.280 | 2 845 | 396.680 | R159 | 94 973.660 | 2 845 | 404.010 | |
| L160 | 95 175.960 | 2 845 | 240.530 | R160 | 95 153.360 | 2 845 | 216.540 | |
| L161 | 95 372.220 | 2 845 | 069.430 | R161 | 95 251.260 | 2 845 | 125.910 | |
| L162 | 95 375.400 | 2 845 | 066.650 | R162 | 95 349.520 | 2 845 | 043.190 | |
| L163 | 95 395.170 | 2 845 | 049.030 | R163 | 95 352.830 | 2 845 | 040.400 | |
| L164 | 95 433.630 | 2 845 | 014.730 | R164 | 95 371.720 | 2 845 | 021.980 | |
| L165 | 95 434.290 | 2 845 | 014.130 | R165 | 95 409.240 | 2 844 | 985.380 | |
| L166 | 95 440.830 | 2 845 | 007.880 | R166 | 95 409.360 | 2 844 | 985.260 | |
| L167 | 95 519.720 | 2 844 | 920.760 | R167 | 95 482.820 | 2 844 | 914.320 | |
| L168 | 95 547.690 | 2 844 | 874.710 | R168 | 95 511.840 | 2 844 | 865.990 | |
| L169 | 95 567.880 | 2 844 | 828.850 | R169 | 95 535.150 | 2 844 | 816.520 | |
| L170 | 95 603.270 | 2 844 | 732.200 | R170 | 95 604.510 | 2 844 | 622.230 | |
| L171 | 95 644.590 | 2 844 | 681.720 | | | | | |
| L172 | 95 664.950 | 2 844 | 668.310 | | | | | |

| | | | | |
|-------|----|-----|----|---------|
| Vel | 12 | Van | 12 | P741/09 |
| Sheet | | of | | |